

ALTERNATIVE ML1 IS THE NO-BUILD ALTERNATIVE. NO PLAN SHEETS ARE PROVIDED FOR THE ML1 NO-BUILD ALTERNATIVES.

NOTE:
CLICK ON BOX BELOW SHEET NO. FOR DIRECT LINK TO SHEET

MAINLINE ALTERNATIVE 3



October 9, 2020

**I-10 / LOOP 202 TO SR 387
WILD HORSE PASS CORRIDOR
KEY MAP - ALTERNATIVE ML3**

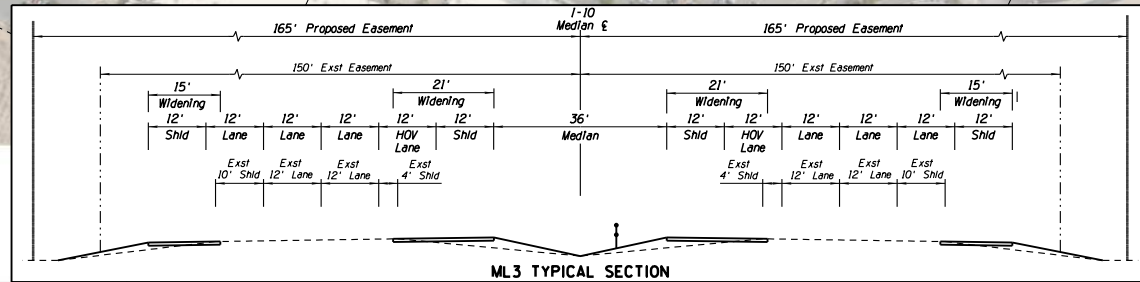
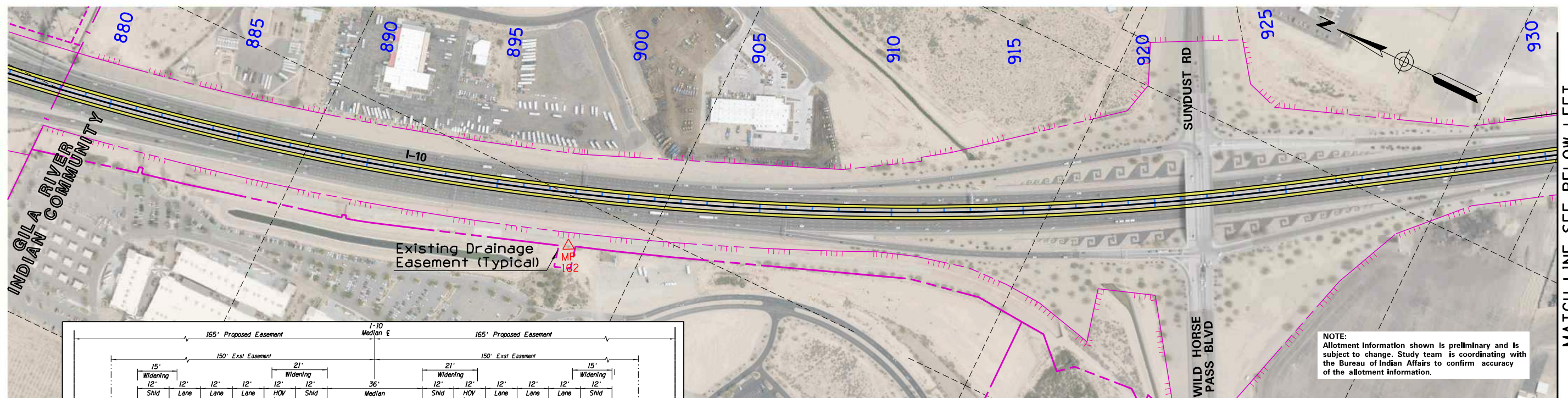

NOTE:
Allotment Information shown is preliminary and is subject to change. Study team is coordinating with the Bureau of Indian Affairs to confirm accuracy of the allotment information.

MATCH LINE SEE BELOW LEFT

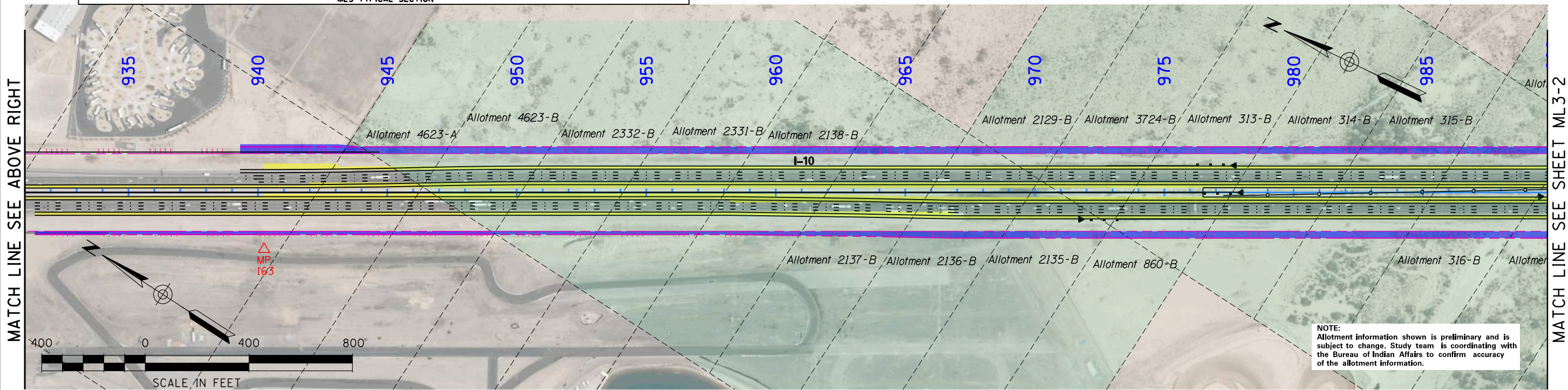

NOTE:
Allotment information shown is preliminary and is subject to change. Study team is coordinating with the Bureau of Indian Affairs to confirm accuracy of the allotment information.

MATCH LINE SEE ABOVE RIGHT

MATCH LINE SEE SHEET ML3-2



October 9, 2020

**I-10 / LOOP 202 TO SR 387
WILD HORSE PASS CORRIDOR
ALTERNATIVE ML3**

Allotment Parcels	Temporary Construction Easements	Land Boundary
New Pavement	Existing Easement (Line)	Median Cable Barrier
New Permanent Easements	Control of Access (Hash Marks)	
	MP Milepost	

**ML3-1
SHEET 1 of 12**

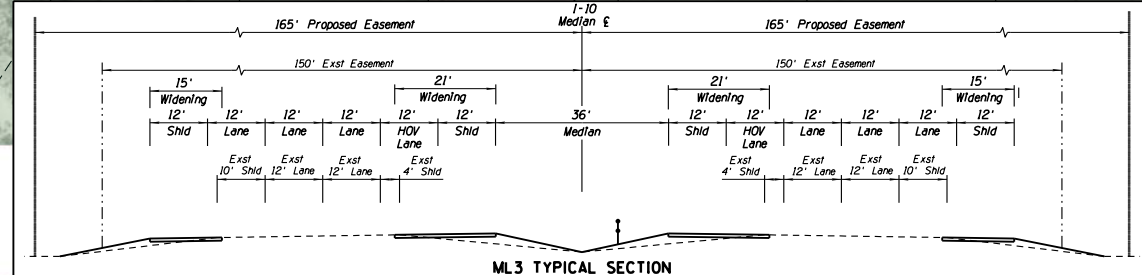
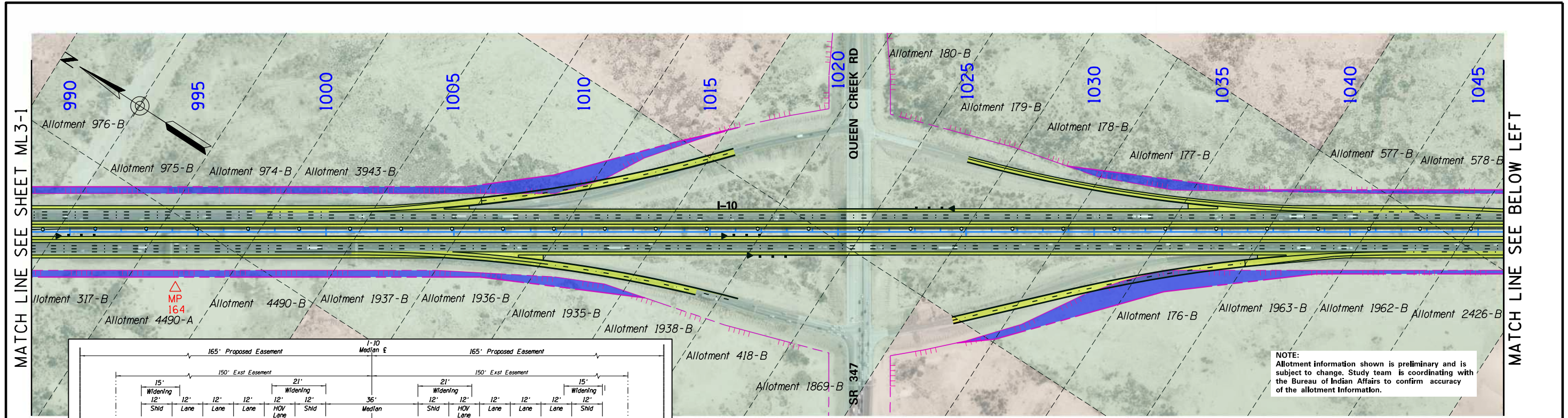

NOTE:
Allotment information shown is preliminary and is subject to change. Study team is coordinating with the Bureau of Indian Affairs to confirm accuracy of the allotment information.

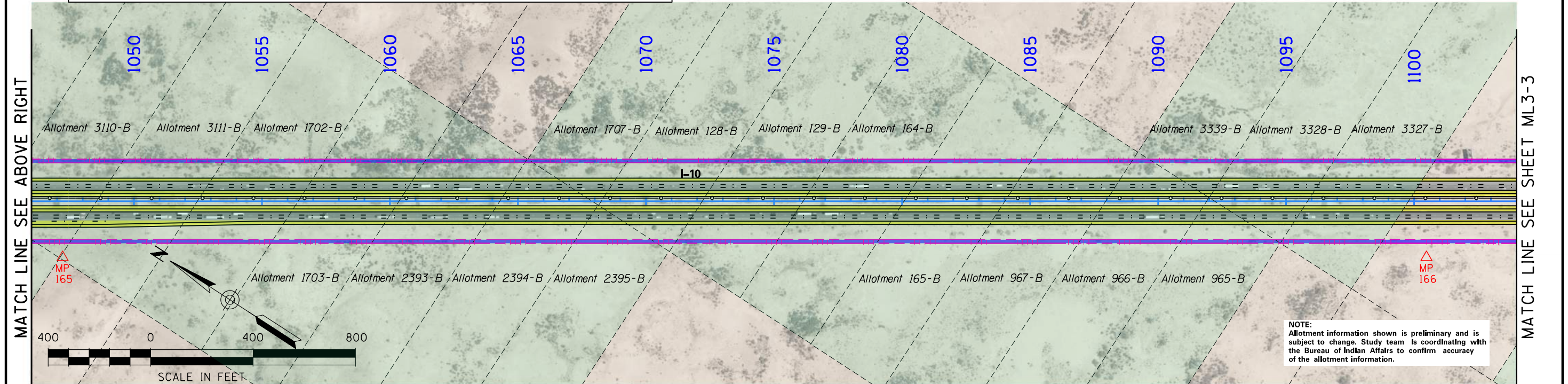

NOTE:
Allotment information shown is preliminary and is subject to change. Study team is coordinating with the Bureau of Indian Affairs to confirm accuracy of the allotment information.



October 9, 2020

I-10 / LOOP 202 TO SR 387
WILD HORSE PASS CORRIDOR
ALTERNATIVE ML3

Allotment Parcels	Temporary Construction Easements	Land Boundary
New Pavement	Existing Easement (Line)	Median Cable Barrier
New Permanent Easements	Control of Access (Hash Marks)	
	Milepost	

MATCH LINE SEE SHEET ML3-2

MATCH LINE SEE BELOW LEFT

MATCH LINE SEE ABOVE RIGHT

MATCH LINE SEE SHEET ML3-4

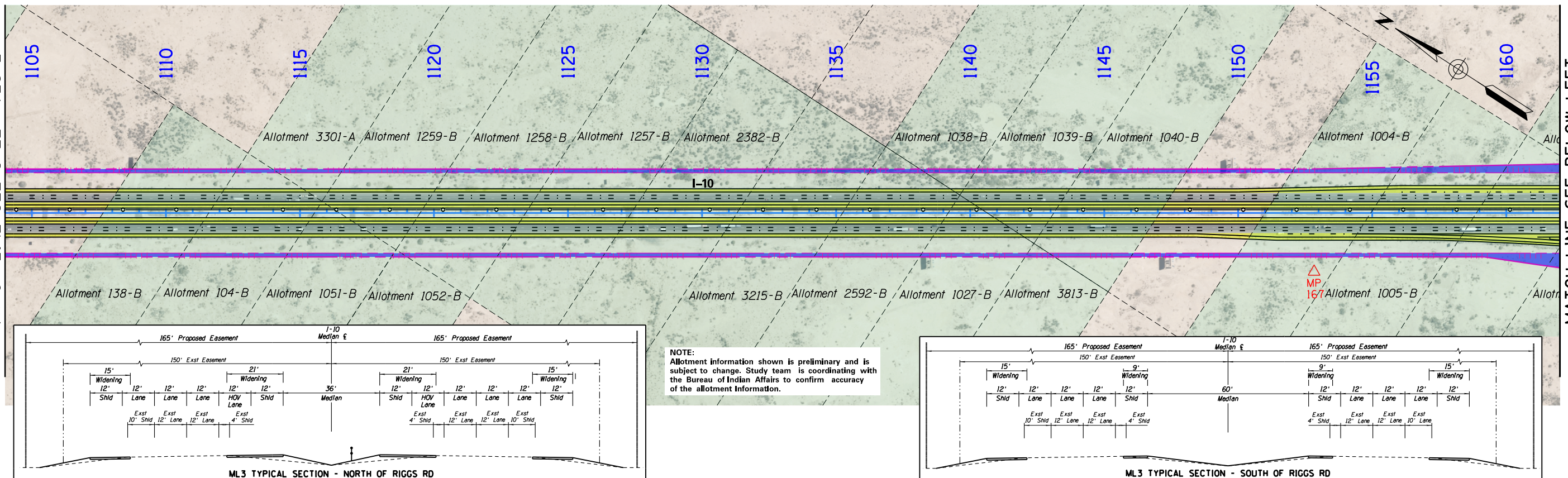

NOTE:
Allotment information shown is preliminary and is subject to change. Study team is coordinating with the Bureau of Indian Affairs to confirm accuracy of the allotment information.

NOTE:
Allotment information shown is preliminary and is subject to change. Study team is coordinating with the Bureau of Indian Affairs to confirm accuracy of the allotment information.

ML3 MUST BE COMBINED WITH OPTION RR5 - REFER TO THE CROSSROAD EXHIBIT FOR THE OPTION FOR MORE INFORMATION

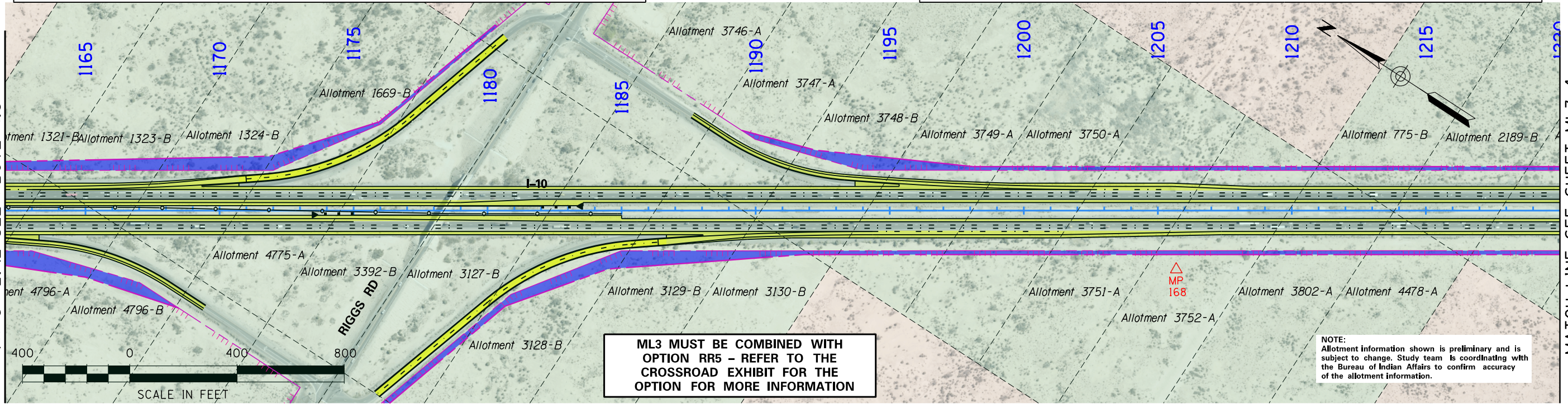

October 9, 2020

I-10 / LOOP 202 TO SR 387
WILD HORSE PASS CORRIDOR
ALTERNATIVE ML3

LEGEND			
	Allotment Parcels		Temporary Construction Easements
	New Pavement		Existing Easement (Line) Control of Access (Hash Marks)
	New Permanent Easements		MP Milepost
	Land Boundary		Median Cable Barrier

ML3-3
SHEET 3 of 12

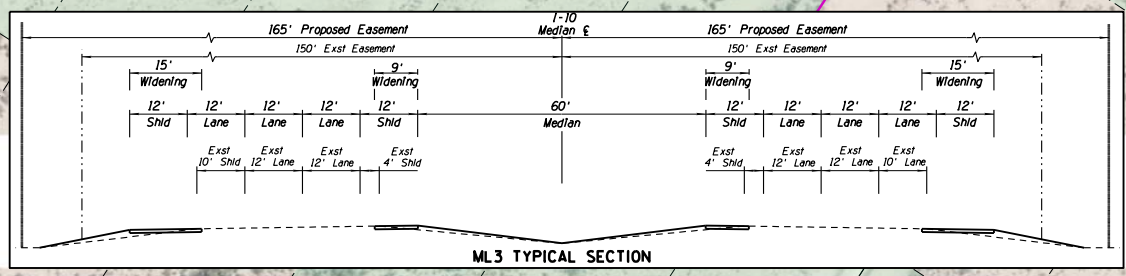
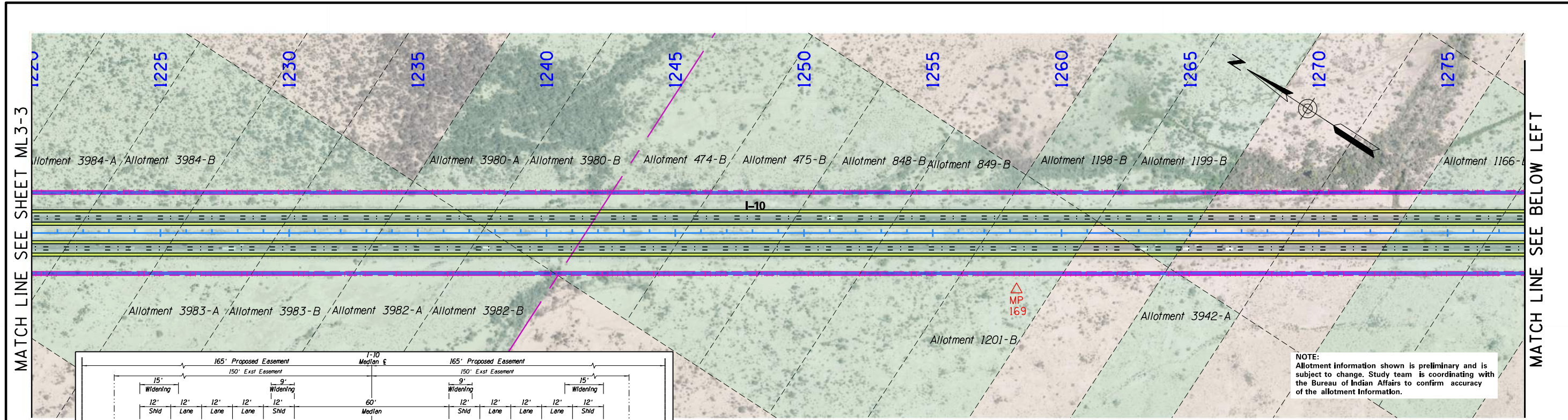

NOTE: Allotment information shown is preliminary and is subject to change. Study team is coordinating with the Bureau of Indian Affairs to confirm accuracy of the allotment information.

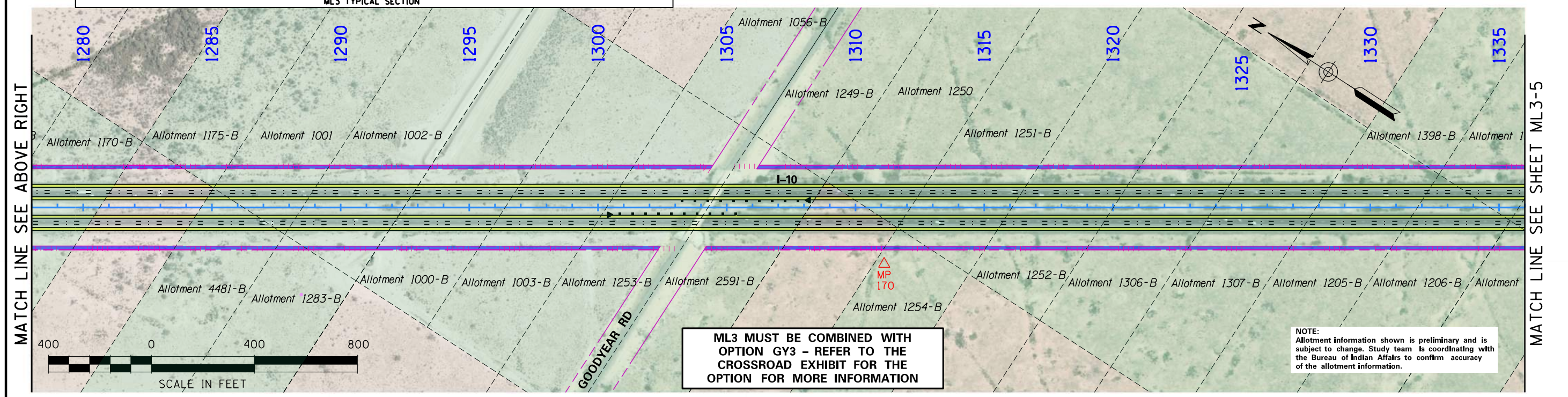

ML3 MUST BE COMBINED WITH OPTION GY3 - REFER TO THE CROSSROAD EXHIBIT FOR THE OPTION FOR MORE INFORMATION

NOTE: Allotment information shown is preliminary and is subject to change. Study team is coordinating with the Bureau of Indian Affairs to confirm accuracy of the allotment information.



October 9, 2020

**I-10 / LOOP 202 TO SR 387
WILD HORSE PASS CORRIDOR
ALTERNATIVE ML3**

Allotment Parcels	Temporary Construction Easements	Land Boundary
New Pavement	Existing Easement (Line)	Median Cable Barrier
New Permanent Easements	Control of Access (Hash Marks)	Milepost

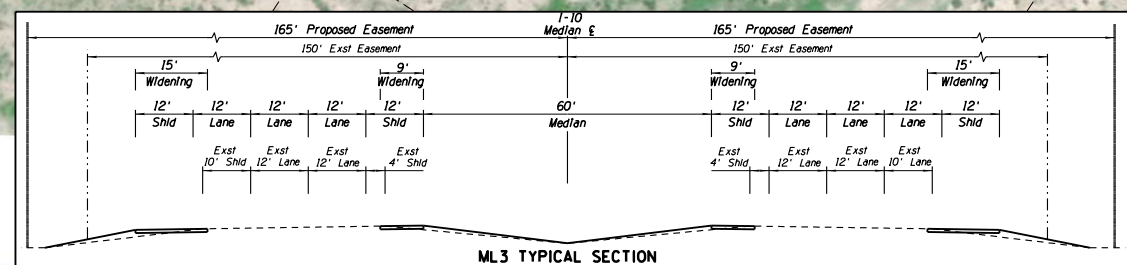
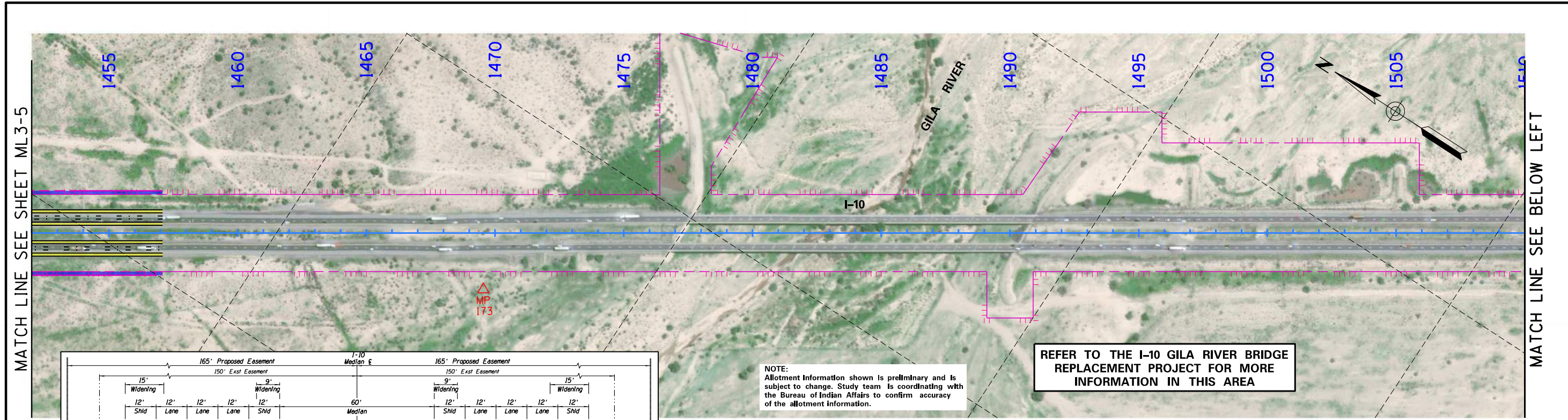

NOTE:
Allotment information shown is preliminary and is subject to change. Study team is coordinating with the Bureau of Indian Affairs to confirm accuracy of the allotment information.

REFER TO THE I-10 GILA RIVER BRIDGE REPLACEMENT PROJECT FOR MORE INFORMATION IN THIS AREA

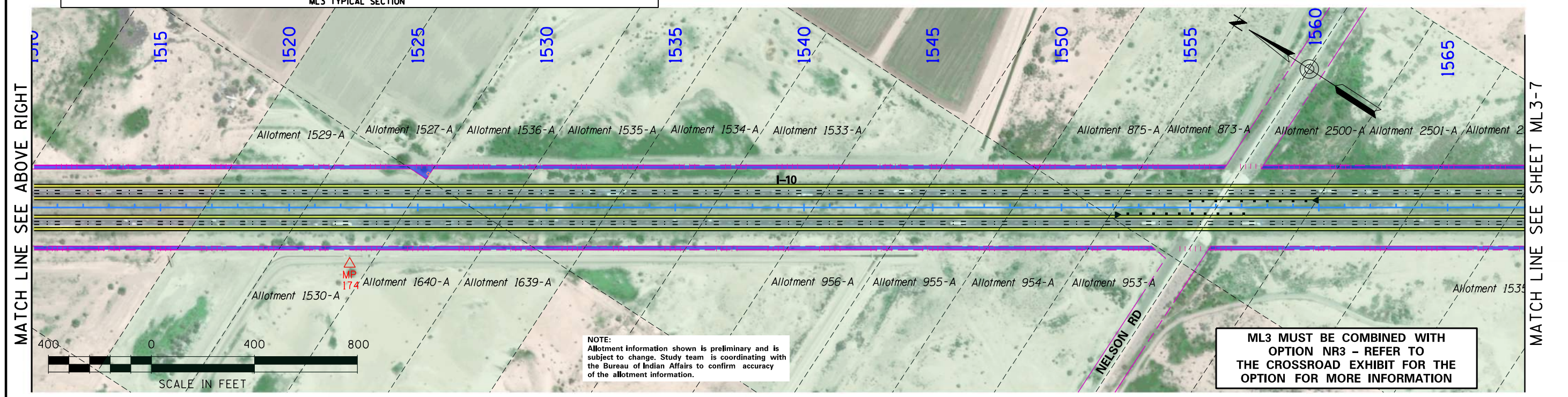

NOTE:
Allotment information shown is preliminary and is subject to change. Study team is coordinating with the Bureau of Indian Affairs to confirm accuracy of the allotment information.

ML3 MUST BE COMBINED WITH OPTION NR3 - REFER TO THE CROSSROAD EXHIBIT FOR THE OPTION FOR MORE INFORMATION



October 9, 2020

I-10 / LOOP 202 TO SR 387
WILD HORSE PASS CORRIDOR
ALTERNATIVE ML3

LEGEND	
	Allotment Parcels
	New Pavement
	New Permanent Easements
	Temporary Construction Easements
	Exst'g Easement (Line)
	Control of Access (Hash Marks)
	Milepost
	Land Boundary
	Median Cable Barrier

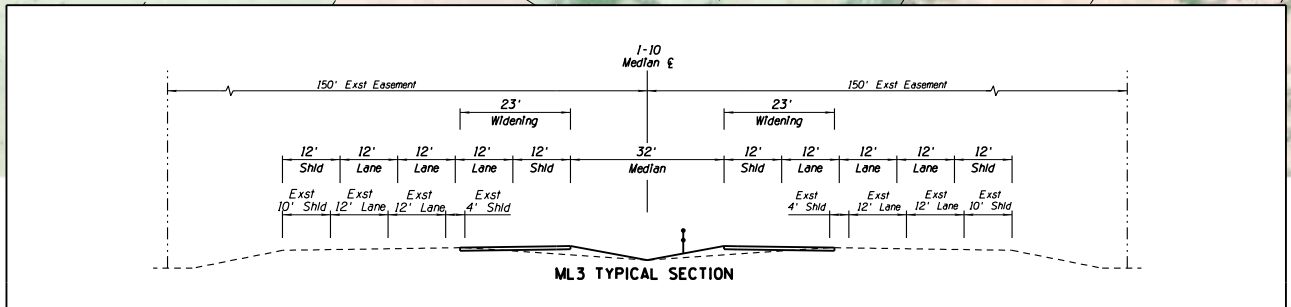
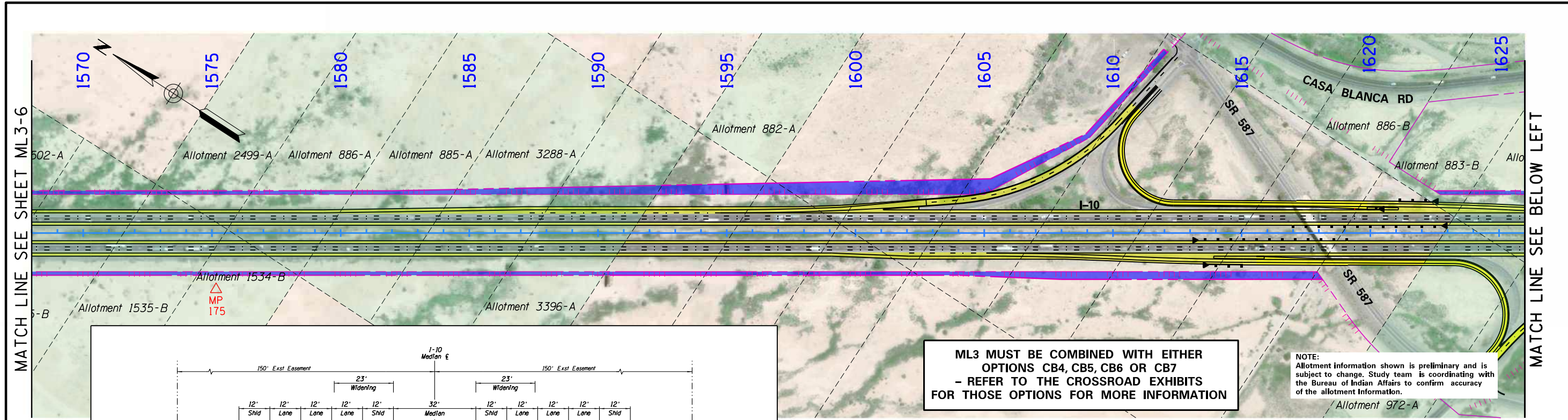

**ML3 MUST BE COMBINED WITH EITHER
 OPTIONS CB4, CB5, CB6 OR CB7
 - REFER TO THE CROSSROAD EXHIBITS
 FOR THOSE OPTIONS FOR MORE INFORMATION**

NOTE:
 Allotment information shown is preliminary and is subject to change. Study team is coordinating with the Bureau of Indian Affairs to confirm accuracy of the allotment information.

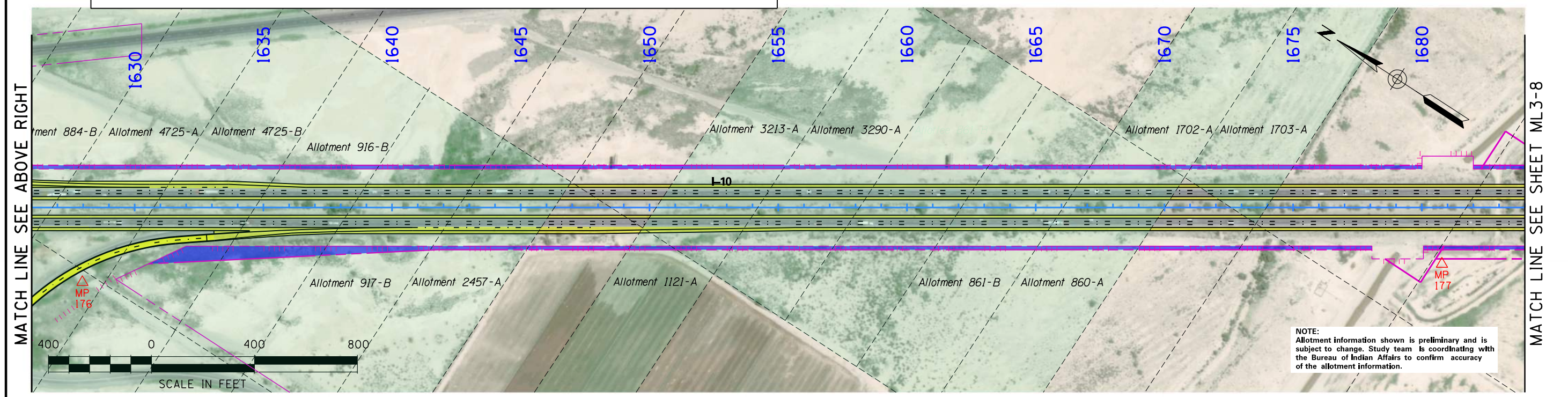

NOTE:
 Allotment information shown is preliminary and is subject to change. Study team is coordinating with the Bureau of Indian Affairs to confirm accuracy of the allotment information.



October 9, 2020

**I-10 / LOOP 202 TO SR 387
 WILD HORSE PASS CORRIDOR
 ALTERNATIVE ML3**

Allotment Parcels	Temporary Construction Easements	Land Boundary
New Pavement	Existing Easement (Line)	Median Cable Barrier
New Permanent Easements	Control of Access (Hash Marks)	
	MP Milepost	

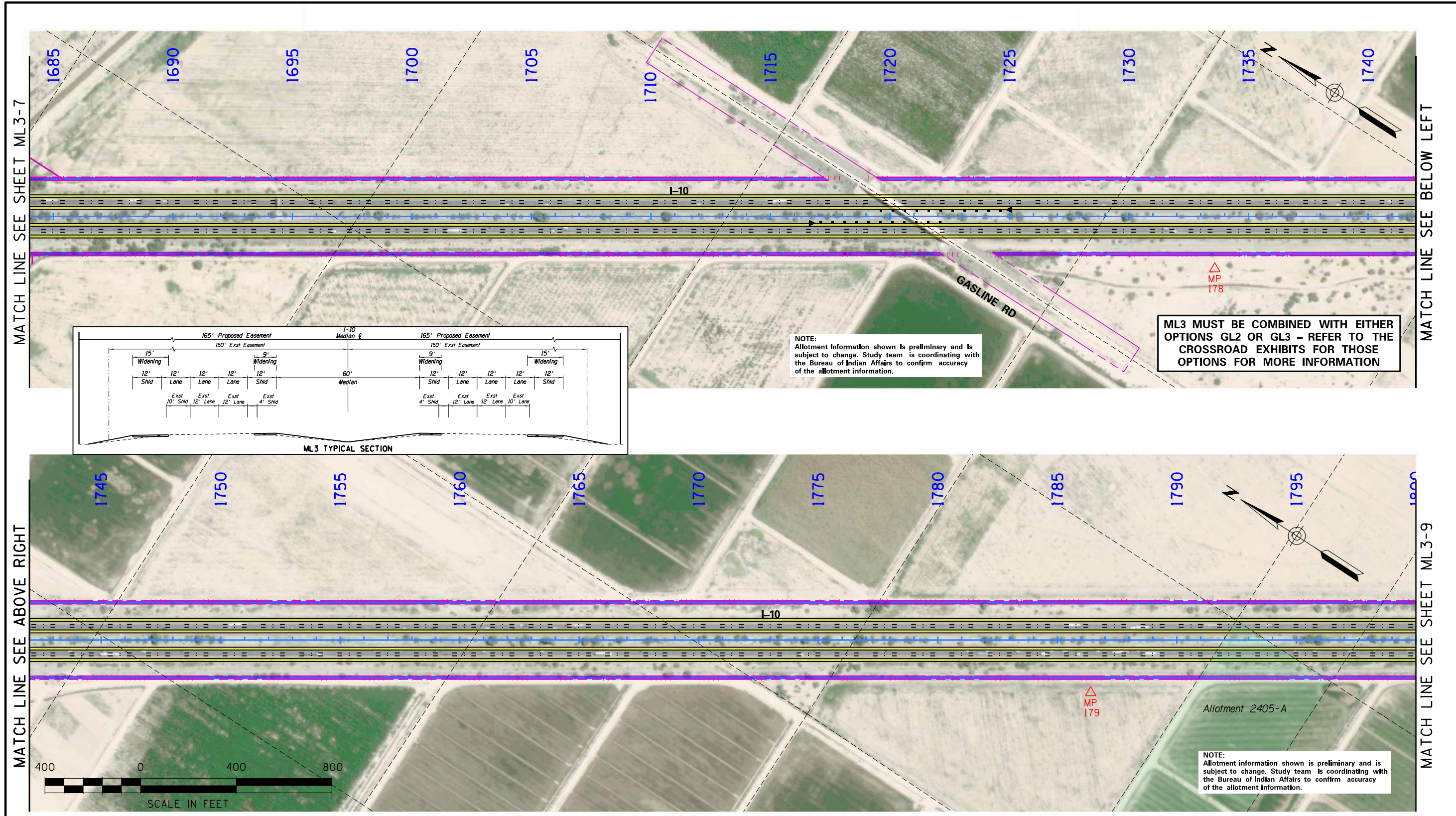

MATCH LINE SEE SHEET ML3-7

MATCH LINE SEE BELOW LEFT

MATCH LINE SEE ABOVE RIGHT

MATCH LINE SEE SHEET ML3-9

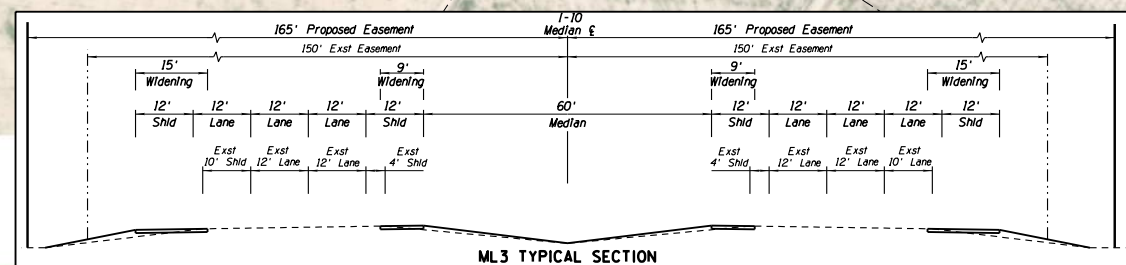

NOTE:
Allotment information shown is preliminary and is subject to change. Study team is coordinating with the Bureau of Indian Affairs to confirm accuracy of the allotment information.

ML3 MUST BE COMBINED WITH EITHER OPTIONS GL2 OR GL3 - REFER TO THE CROSSROAD EXHIBITS FOR THOSE OPTIONS FOR MORE INFORMATION

NOTE:
Allotment information shown is preliminary and is subject to change. Study team is coordinating with the Bureau of Indian Affairs to confirm accuracy of the allotment information.



October 9, 2020

**I-10 / LOOP 202 TO SR 387
WILD HORSE PASS CORRIDOR
ALTERNATIVE ML3**

Allotment Parcels	Temporary Construction Easements	Land Boundary
New Pavement	Existing Easement (Line)	Median Cable Barrier
New Permanent Easements	Control of Access (Hash Marks)	Milepost

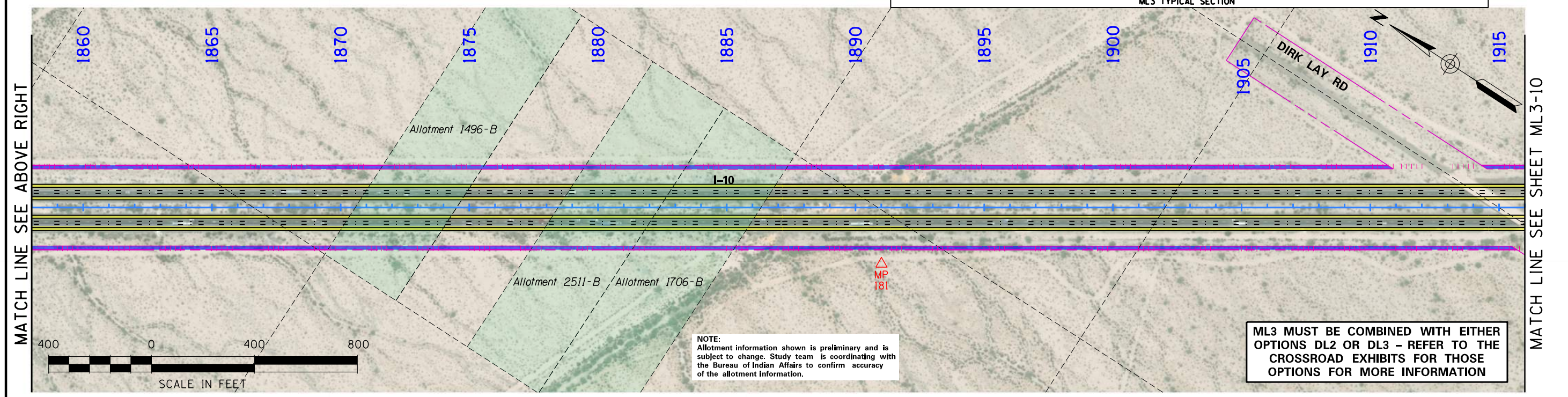
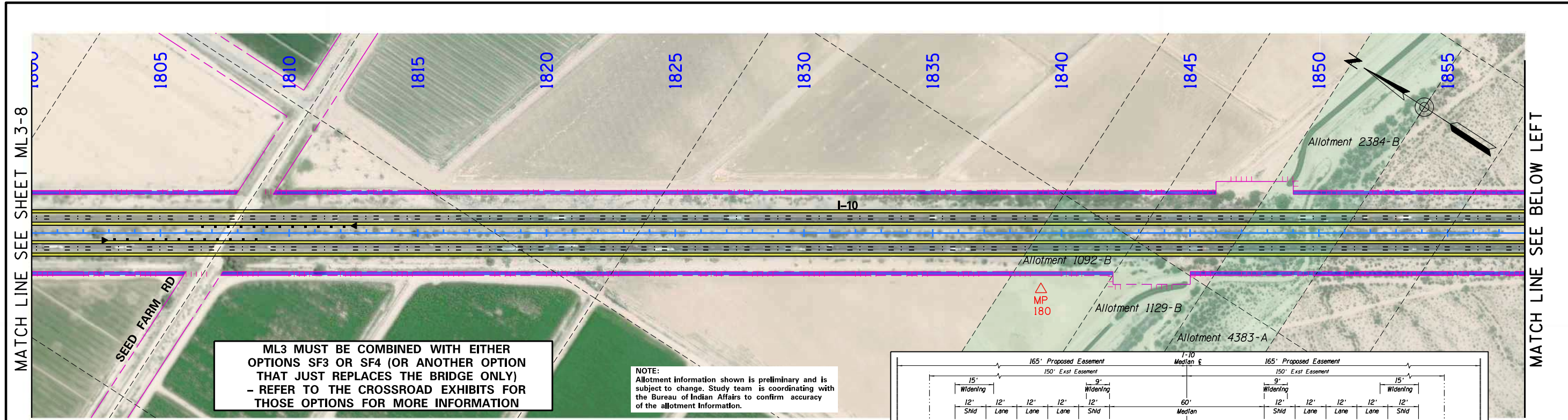

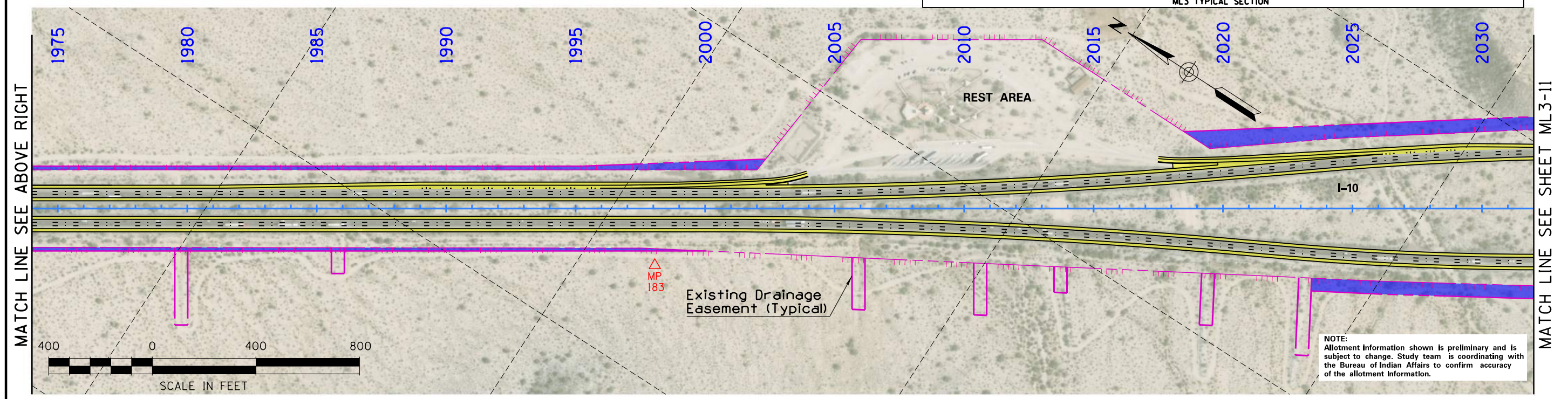
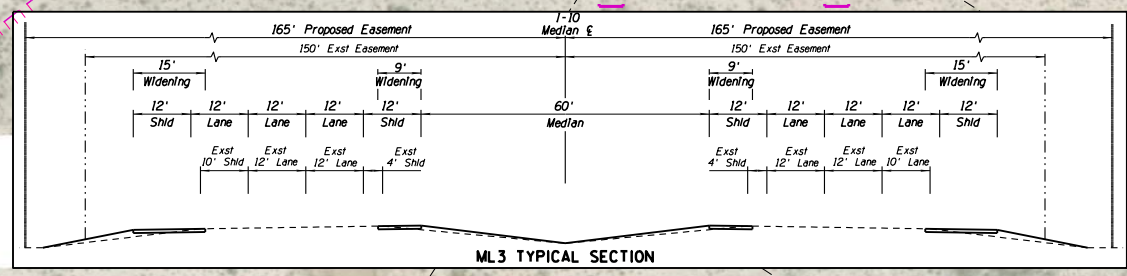
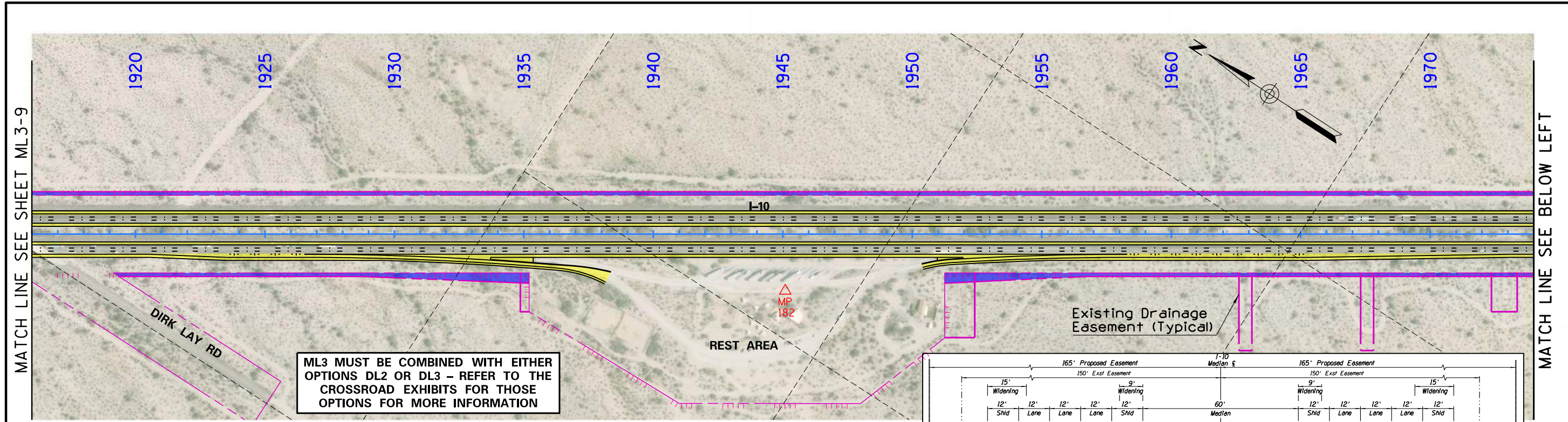

**I-10 / LOOP 202 TO SR 387
WILD HORSE PASS CORRIDOR
ALTERNATIVE ML3**

<ul style="list-style-type: none"> Allotment Parcels New Pavement New Permanent Easements 	<ul style="list-style-type: none"> Temporary Construction Easements Exst'g Easement (Line) Control of Access (Hash Marks) MP Milepost 	<ul style="list-style-type: none"> Land Boundary Median Cable Barrier
---	--	--

**ML3-10
SHEET 10 of 12**

October 9, 2020

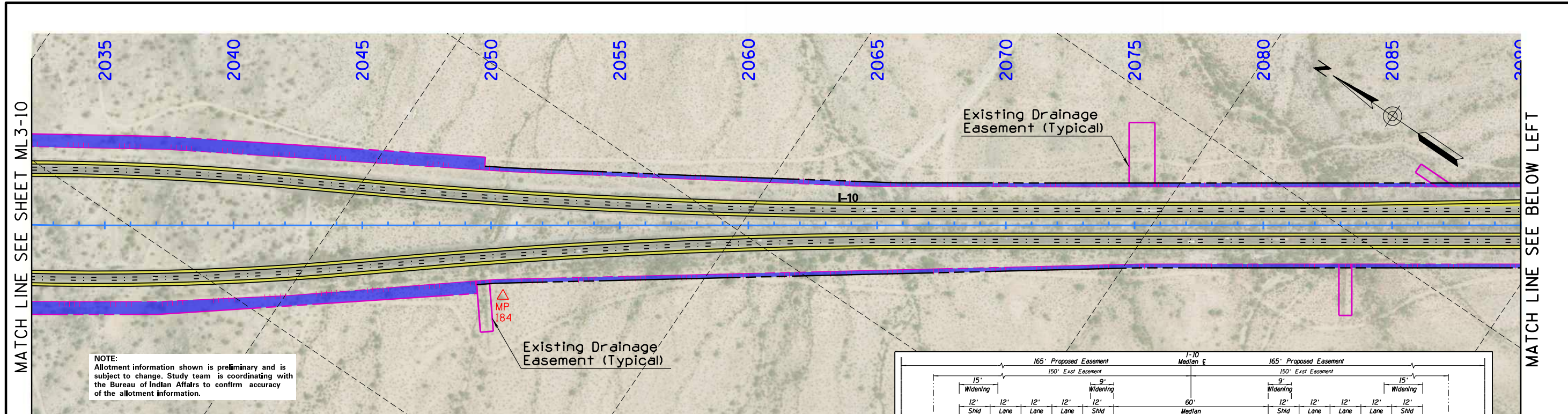

NOTE:
Allotment information shown is preliminary and is subject to change. Study team is coordinating with the Bureau of Indian Affairs to confirm accuracy of the allotment information.

Existing Drainage Easement (Typical)

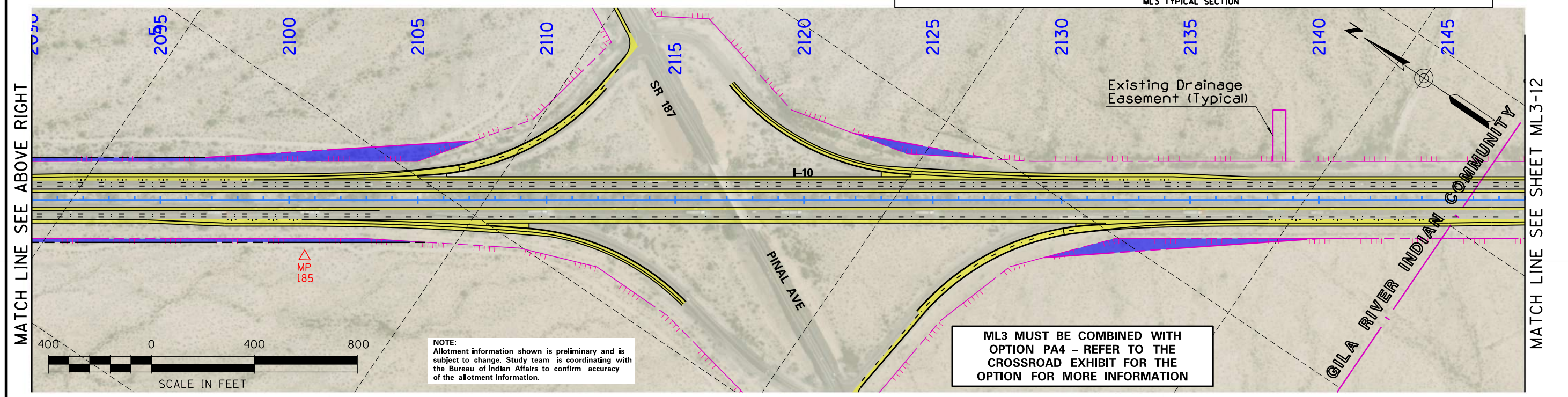
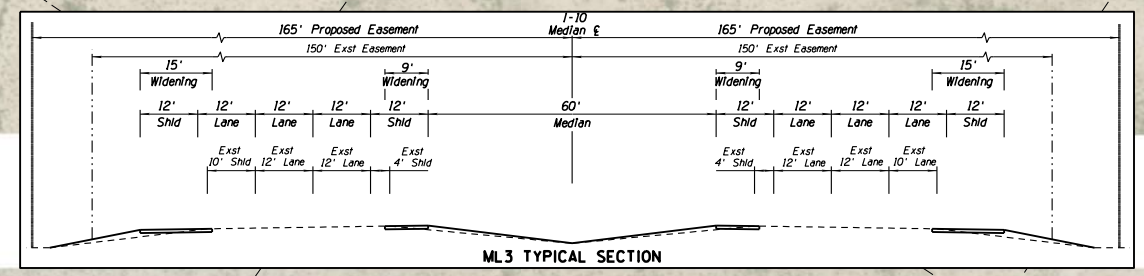

NOTE:
Allotment information shown is preliminary and is subject to change. Study team is coordinating with the Bureau of Indian Affairs to confirm accuracy of the allotment information.

ML3 MUST BE COMBINED WITH OPTION PA4 - REFER TO THE CROSSROAD EXHIBIT FOR THE OPTION FOR MORE INFORMATION

**I-10 / LOOP 202 TO SR 387
WILD HORSE PASS CORRIDOR
ALTERNATIVE ML3**

LEGEND

 Allotment Parcels	 Temporary Construction Easements	 Land Boundary
 New Pavement	 Existing Easement (Line)	 Median Cable Barrier
 New Permanent Easements	 Control of Access (Hash Marks)	 Milepost

**ML3-11
SHEET 11 of 12**

October 9, 2020

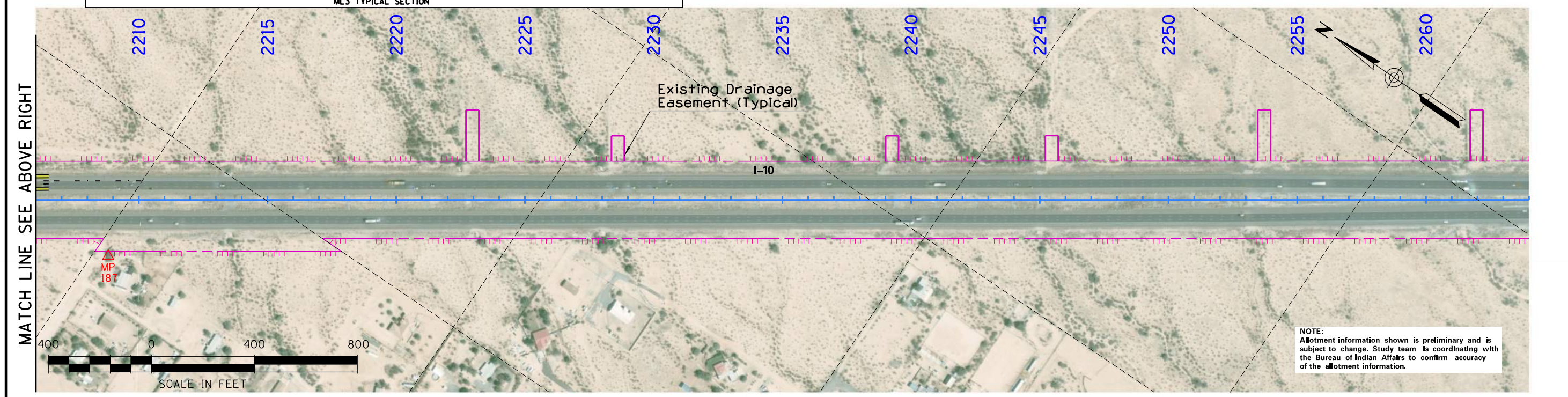
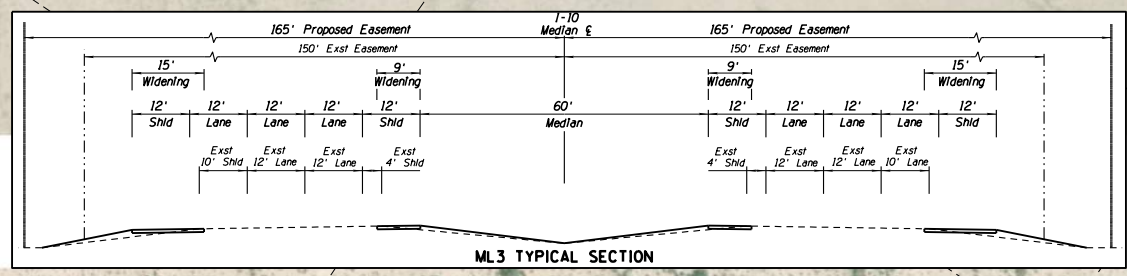
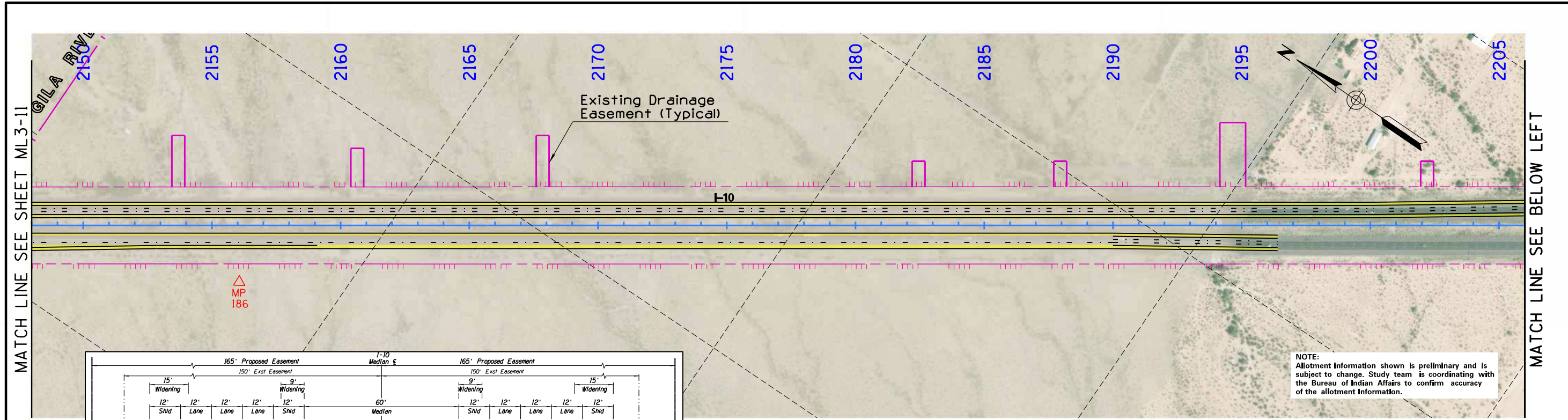

**I-10 / LOOP 202 TO SR 387
WILD HORSE PASS CORRIDOR
ALTERNATIVE ML3**

Allotment Parcels

New Pavement

New Permanent Easements

Temporary Construction Easements

Existing Easement (Line)

Control of Access (Hash Marks)

MP Milepost

Land Boundary

Median Cable Barrier

**ML3-12
SHEET 12 of 12**

October 9, 2020