

ALTERNATIVE ML1 IS THE NO-BUILD ALTERNATIVE. NO PLAN SHEETS ARE PROVIDED FOR THE ML1 NO-BUILD ALTERNATIVES.

NOTE:  
CLICK ON BOX BELOW SHEET NO. FOR DIRECT LINK TO SHEET

**MAINLINE ALTERNATIVE 2**



October 9, 2020

**I-10 / LOOP 202 TO SR 387  
WILD HORSE PASS CORRIDOR  
KEY MAP - ALTERNATIVE ML2**

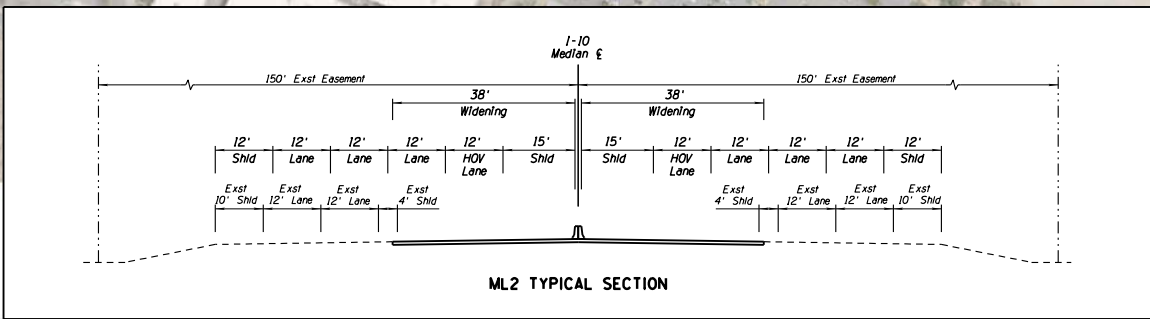
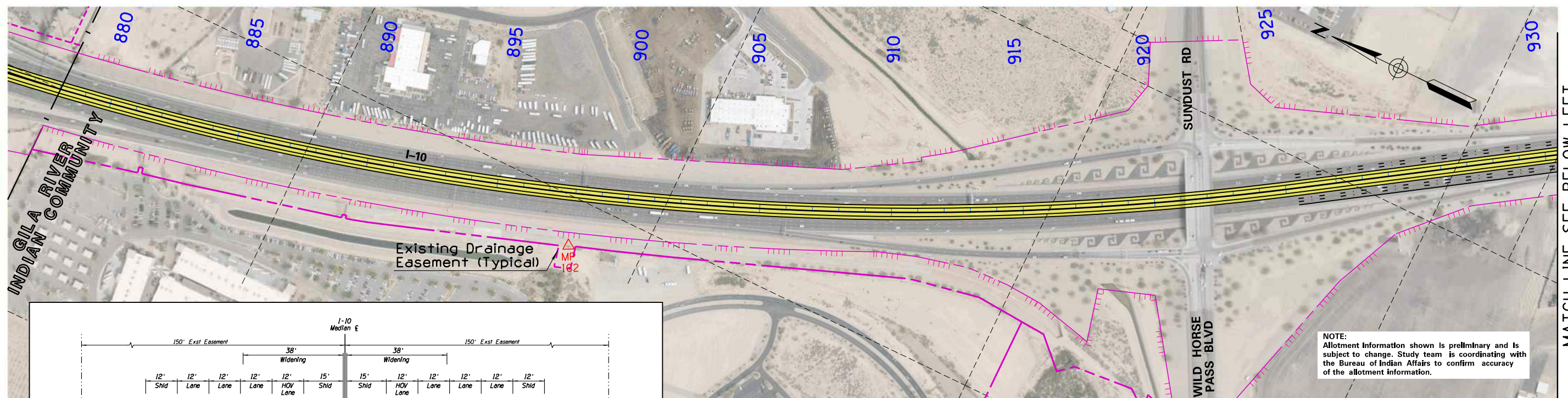

NOTE:  
Allotment information shown is preliminary and is subject to change. Study team is coordinating with the Bureau of Indian Affairs to confirm accuracy of the allotment information.

MATCH LINE SEE BELOW LEFT

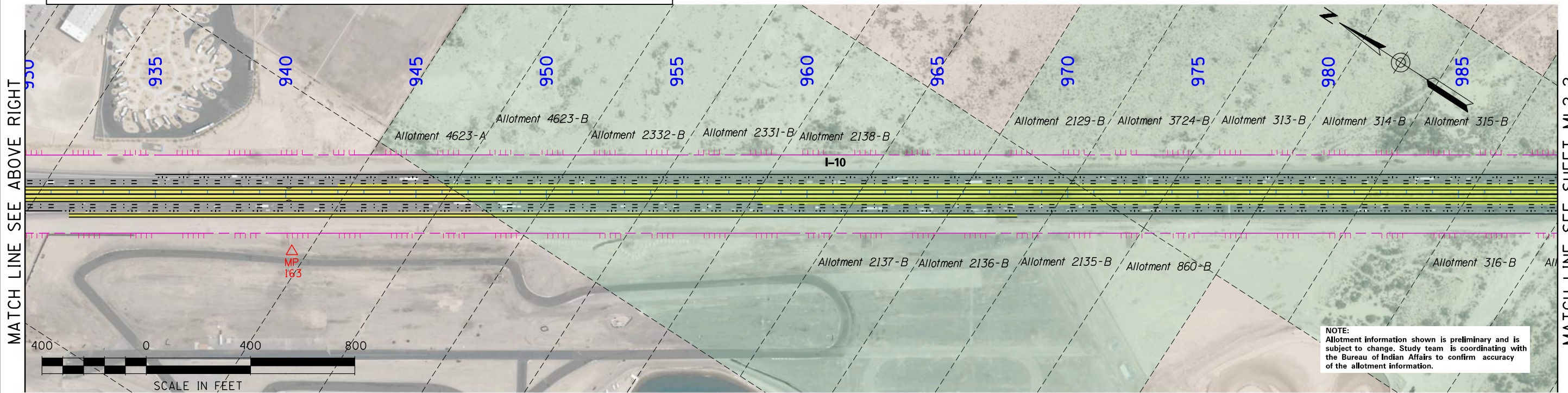

NOTE:  
Allotment information shown is preliminary and is subject to change. Study team is coordinating with the Bureau of Indian Affairs to confirm accuracy of the allotment information.

MATCH LINE SEE ABOVE RIGHT

MATCH LINE SEE SHEET ML2-2



October 9, 2020

**I-10 / LOOP 202 TO SR 387  
WILD HORSE PASS CORRIDOR  
ALTERNATIVE ML2**

	Allotment Parcels		Temporary Construction Easements		Land Boundary
	New Pavement		Existing Easement (Line) Control of Access (Hash Marks)		Median Cable Barrier
	New Permanent Easements		MP Milepost		

**ML2-1  
SHEET 1 of 12**

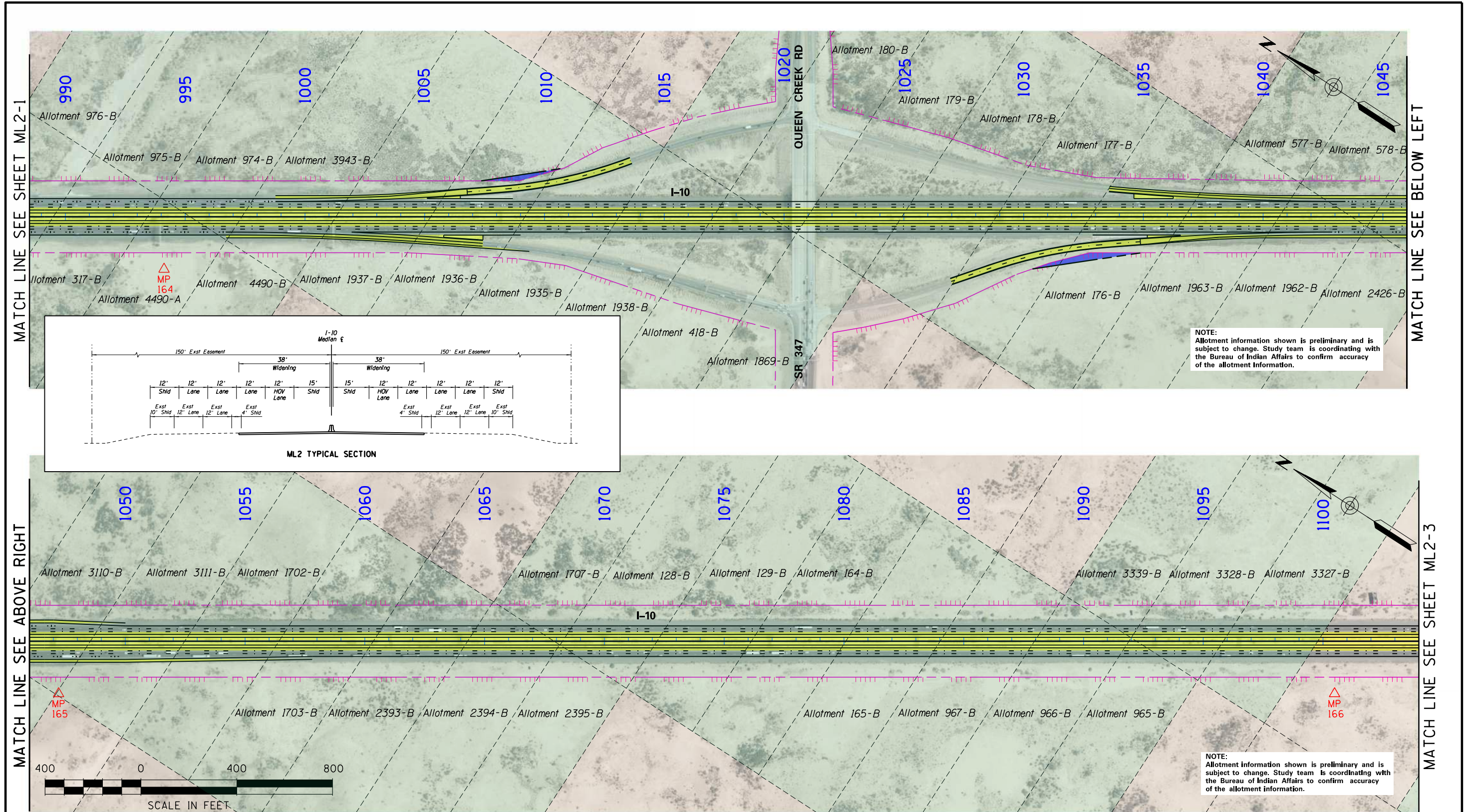

MATCH LINE SEE SHEET ML2-1

MATCH LINE SEE BELOW LEFT

MATCH LINE SEE ABOVE RIGHT

MATCH LINE SEE SHEET ML2-3

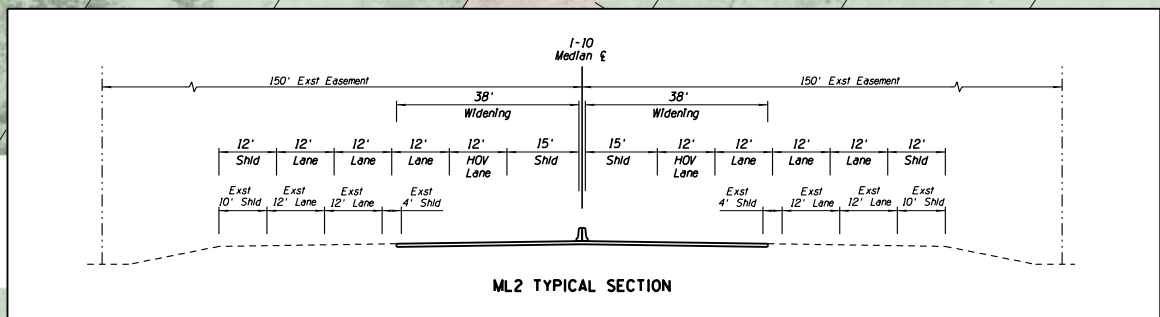

**NOTE:**  
Allotment information shown is preliminary and is subject to change. Study team is coordinating with the Bureau of Indian Affairs to confirm accuracy of the allotment information.

**NOTE:**  
Allotment information shown is preliminary and is subject to change. Study team is coordinating with the Bureau of Indian Affairs to confirm accuracy of the allotment information.



October 9, 2020

**I-10 / LOOP 202 TO SR 387  
WILD HORSE PASS CORRIDOR  
ALTERNATIVE ML2**

Allotment Parcels	Temporary Construction Easements	Land Boundary
New Pavement	Existing Easement (Line) Control of Access (Hash Marks)	Median Cable Barrier
New Permanent Easements	Milepost	

NOTE:  
Allotment information shown is preliminary and is subject to change. Study team is coordinating with the Bureau of Indian Affairs to confirm accuracy of the allotment information.

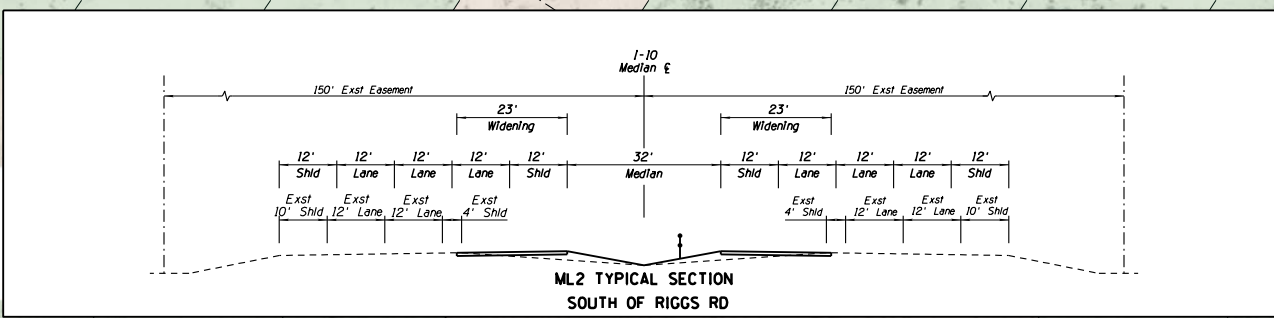
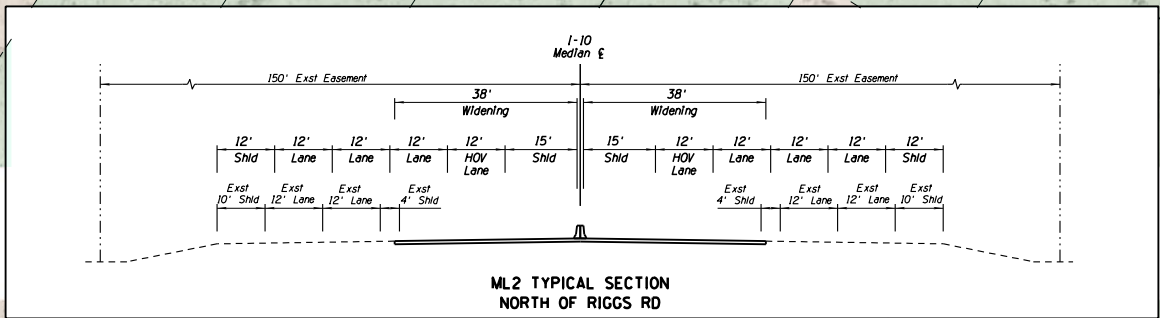
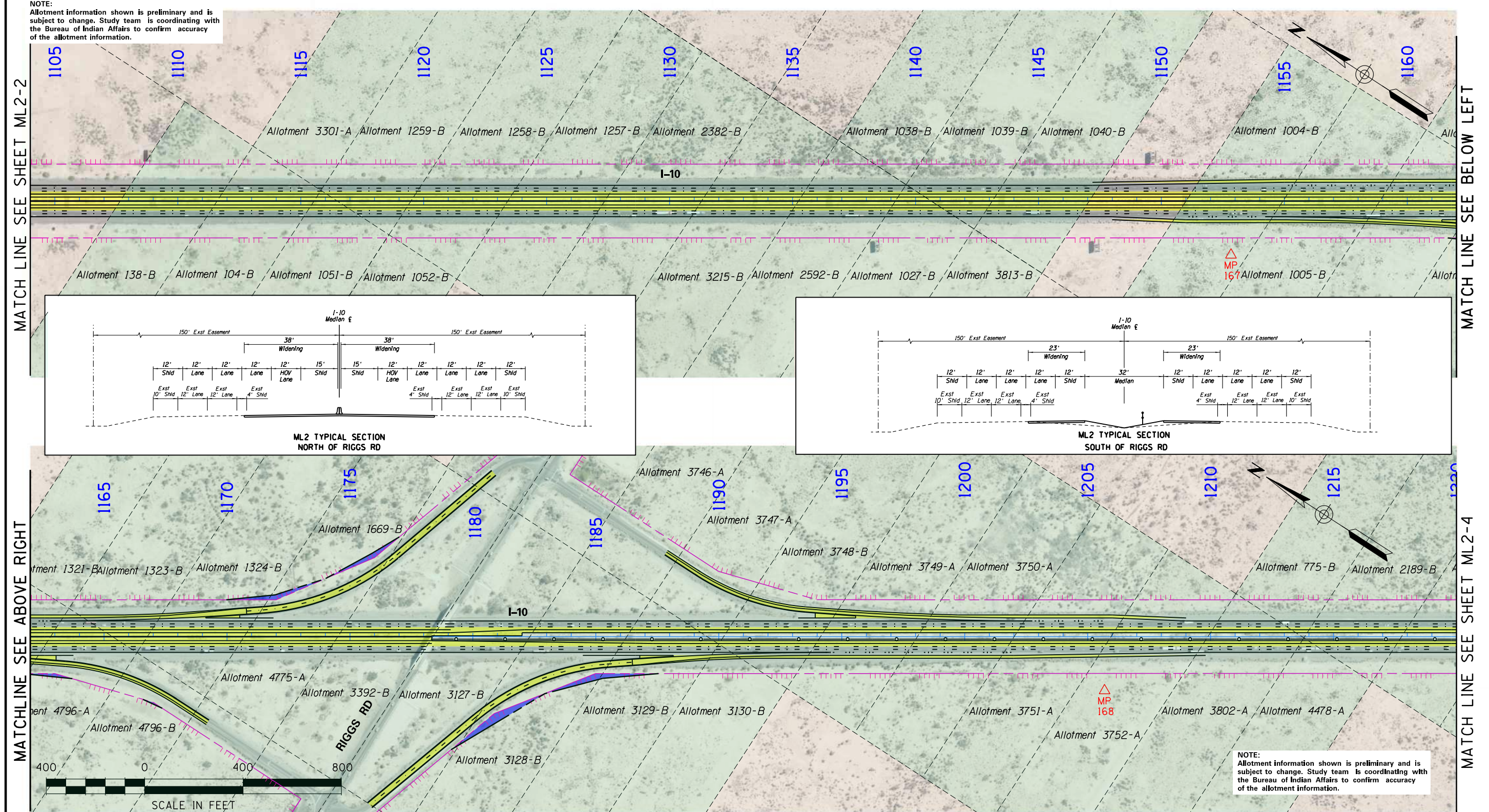

MATCHLINE SEE ABOVE RIGHT

MATCHLINE SEE BELOW LEFT

MATCHLINE SEE SHEET ML2-4

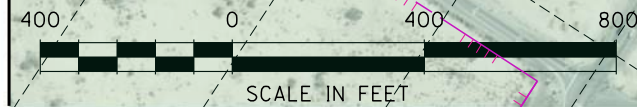

NOTE:  
Allotment information shown is preliminary and is subject to change. Study team is coordinating with the Bureau of Indian Affairs to confirm accuracy of the allotment information.



October 9, 2020

**I-10 / LOOP 202 TO SR 387  
WILD HORSE PASS CORRIDOR  
ALTERNATIVE ML2**

Allotment Parcels	Temporary Construction Easements	Land Boundary
New Pavement	Existing Easement (Line) Control of Access (Hash Marks)	Median Cable Barrier
New Permanent Easements	MP Milepost	

**ML2-3  
SHEET 3 of 12**

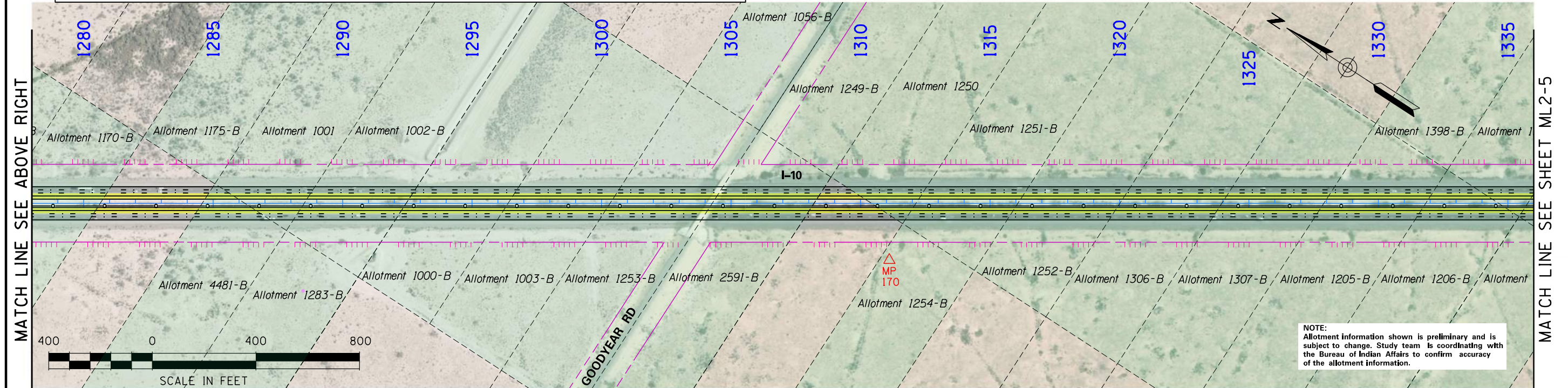
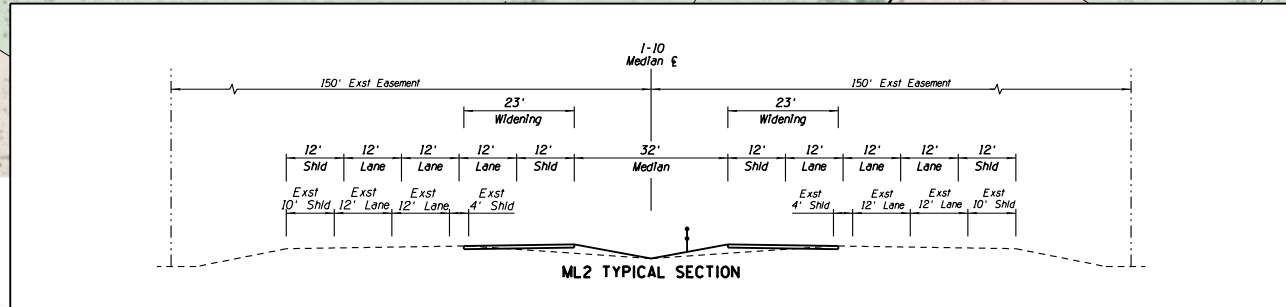
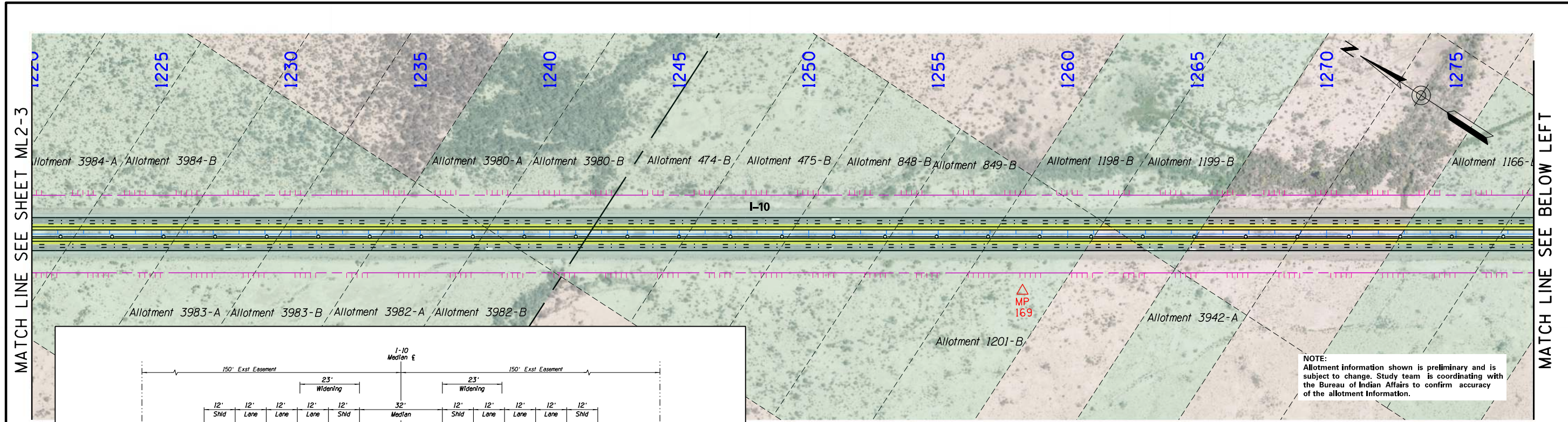

October 9, 2020

**I-10 / LOOP 202 TO SR 387  
WILD HORSE PASS CORRIDOR  
ALTERNATIVE ML2**

**LEGEND**

- Allotment Parcels
- New Pavement
- New Permanent Easements
- Temporary Construction Easements
- Existing Easement (Line)
- Control of Access (Hash Marks)
- MP Milepost
- Land Boundary
- Median Cable Barrier

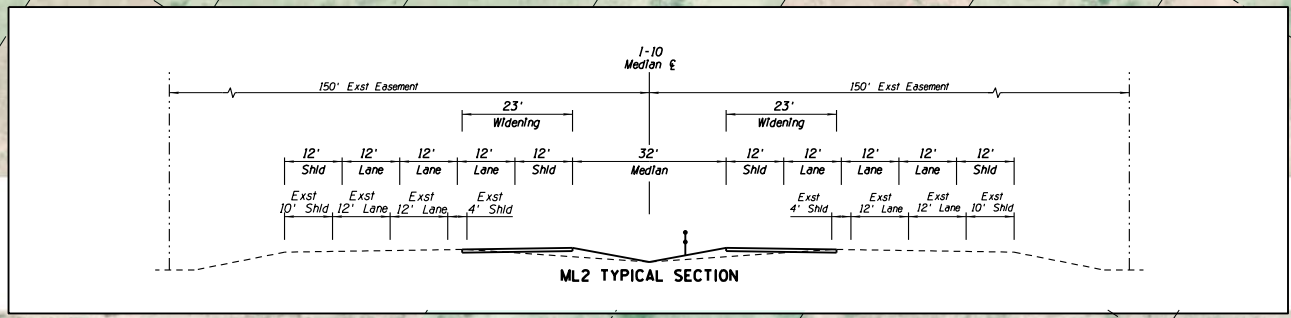
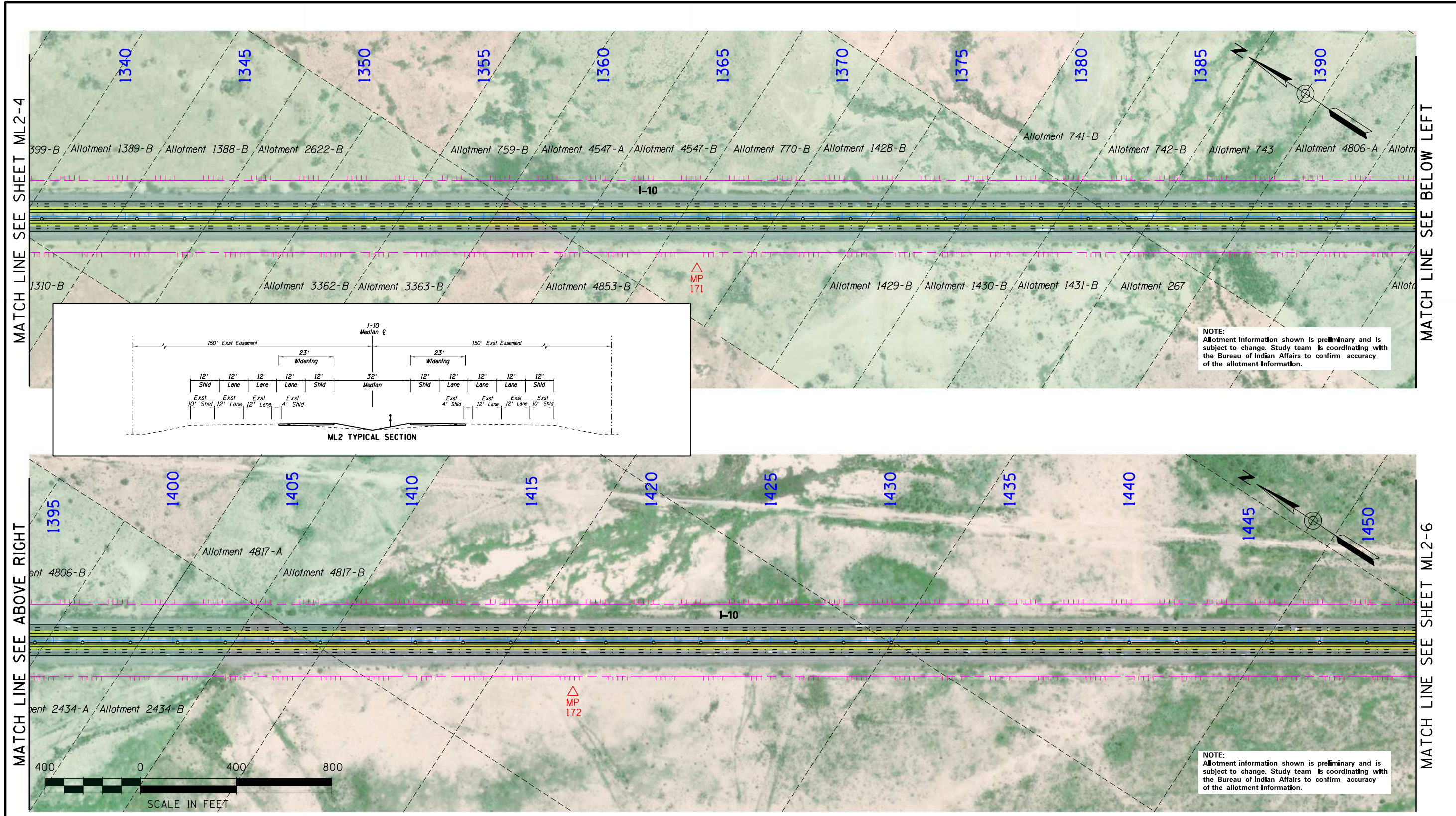

MATCH LINE SEE SHEET ML2-4

MATCH LINE SEE BELOW LEFT

MATCH LINE SEE ABOVE RIGHT

MATCH LINE SEE SHEET ML2-6



October 9, 2020

**I-10 / LOOP 202 TO SR 387  
WILD HORSE PASS CORRIDOR  
ALTERNATIVE ML2**

Allotment Parcels	Temporary Construction Easements	Land Boundary
New Pavement	Existing Easement (Line) Control of Access (Hash Marks)	Median Cable Barrier
New Permanent Easements	Milepost	

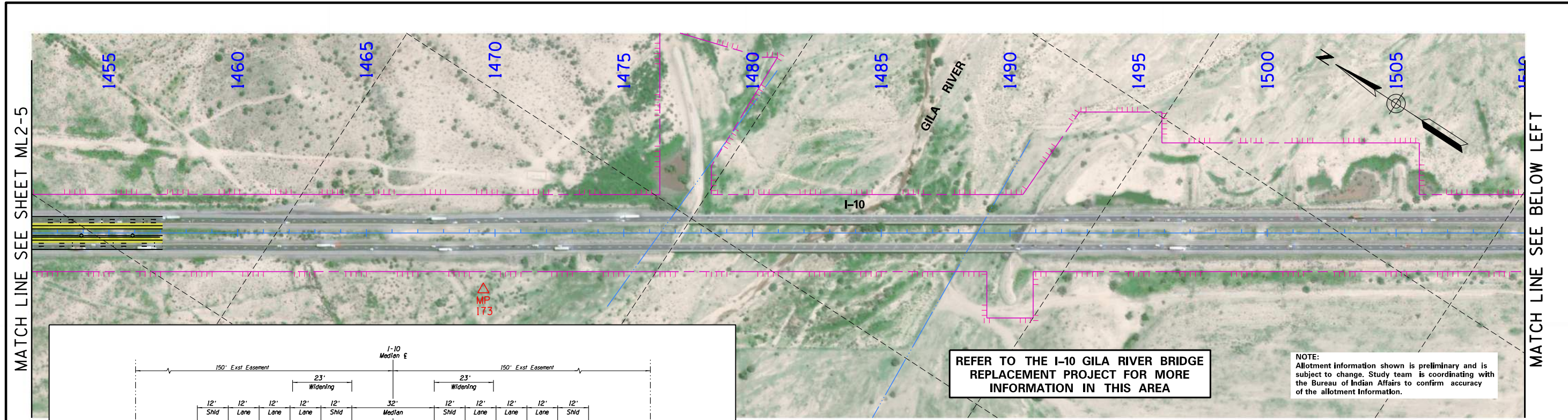

MATCH LINE SEE SHEET ML2-5

MATCH LINE SEE BELOW LEFT

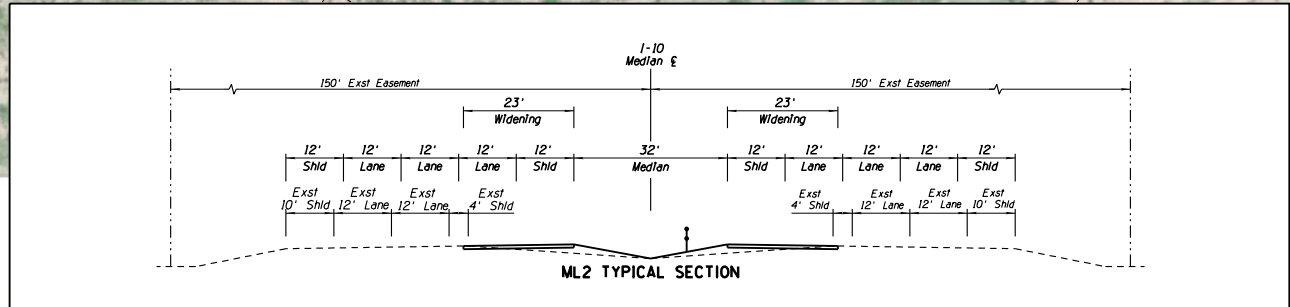

**REFER TO THE I-10 GILA RIVER BRIDGE REPLACEMENT PROJECT FOR MORE INFORMATION IN THIS AREA**

**NOTE:**  
Allotment information shown is preliminary and is subject to change. Study team is coordinating with the Bureau of Indian Affairs to confirm accuracy of the allotment information.

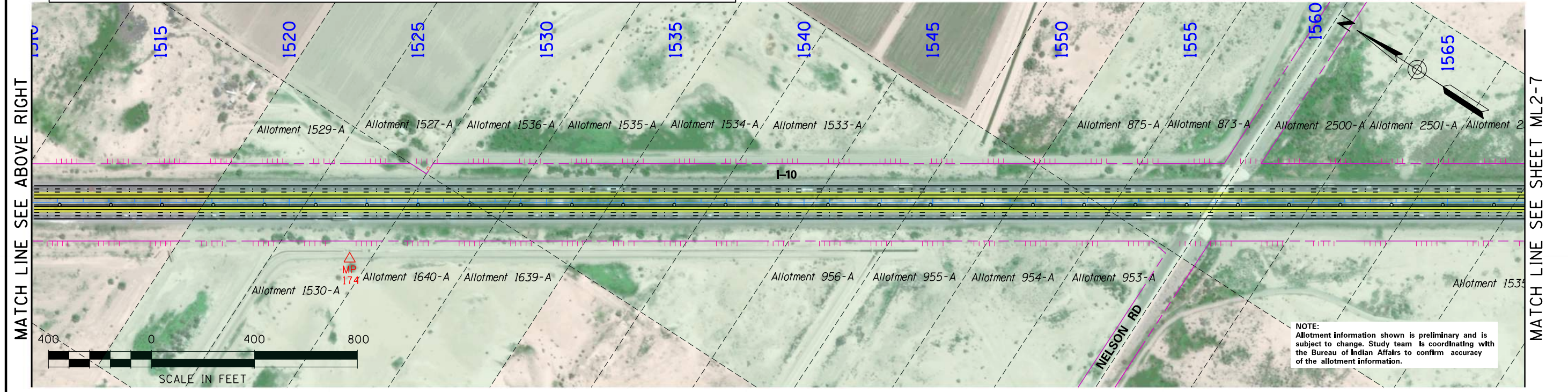

MATCH LINE SEE ABOVE RIGHT

MATCH LINE SEE SHEET ML2-7



**NOTE:**  
Allotment information shown is preliminary and is subject to change. Study team is coordinating with the Bureau of Indian Affairs to confirm accuracy of the allotment information.

**I-10 / LOOP 202 TO SR 387  
WILD HORSE PASS CORRIDOR  
ALTERNATIVE ML2**

<ul style="list-style-type: none"> <li><span style="display: inline-block; width: 20px; height: 10px; background-color: #90EE90; border: 1px solid black; margin-right: 5px;"></span> Allotment Parcels</li> <li><span style="display: inline-block; width: 20px; height: 10px; background-color: #FFFF00; border: 1px solid black; margin-right: 5px;"></span> New Pavement</li> <li><span style="display: inline-block; width: 20px; height: 10px; background-color: #0000FF; border: 1px solid black; margin-right: 5px;"></span> New Permanent Easements</li> </ul>	<ul style="list-style-type: none"> <li><span style="display: inline-block; width: 20px; height: 10px; background-color: #00BFFF; border: 1px solid black; margin-right: 5px;"></span> Temporary Construction Easements</li> <li><span style="display: inline-block; width: 20px; border-bottom: 1px dashed pink; margin-right: 5px;"></span> Existing Easement (Line)</li> <li><span style="display: inline-block; width: 20px; border-bottom: 1px dashed pink; margin-right: 5px;"></span> Control of Access (Hash Marks)</li> <li><span style="color: red; font-weight: bold;">MP</span> Milepost</li> </ul>	<ul style="list-style-type: none"> <li><span style="display: inline-block; width: 20px; border-top: 1px dashed black; margin-right: 5px;"></span> Land Boundary</li> <li><span style="display: inline-block; width: 20px; border-bottom: 1px dashed black; margin-right: 5px;"></span> Median Cable Barrier</li> </ul>
-------------------------------------------------------------------------------------------------------------------------------------------------------------------------------------------------------------------------------------------------------------------------------------------------------------------------------------------------------------------------------------------------------------------------------------------------------------------------------------------------------------------------------------------------------------------------	----------------------------------------------------------------------------------------------------------------------------------------------------------------------------------------------------------------------------------------------------------------------------------------------------------------------------------------------------------------------------------------------------------------------------------------------------------------------------------------------------------------------------------------------------------------------------------------------------------------	------------------------------------------------------------------------------------------------------------------------------------------------------------------------------------------------------------------------------------------------------------------------------------------------------------------------

**ML2-6  
SHEET 6 of 12**

**October 9, 2020**

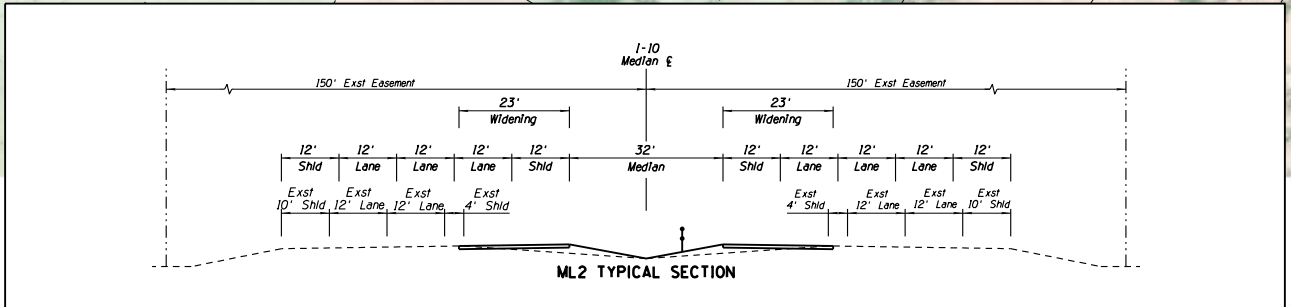
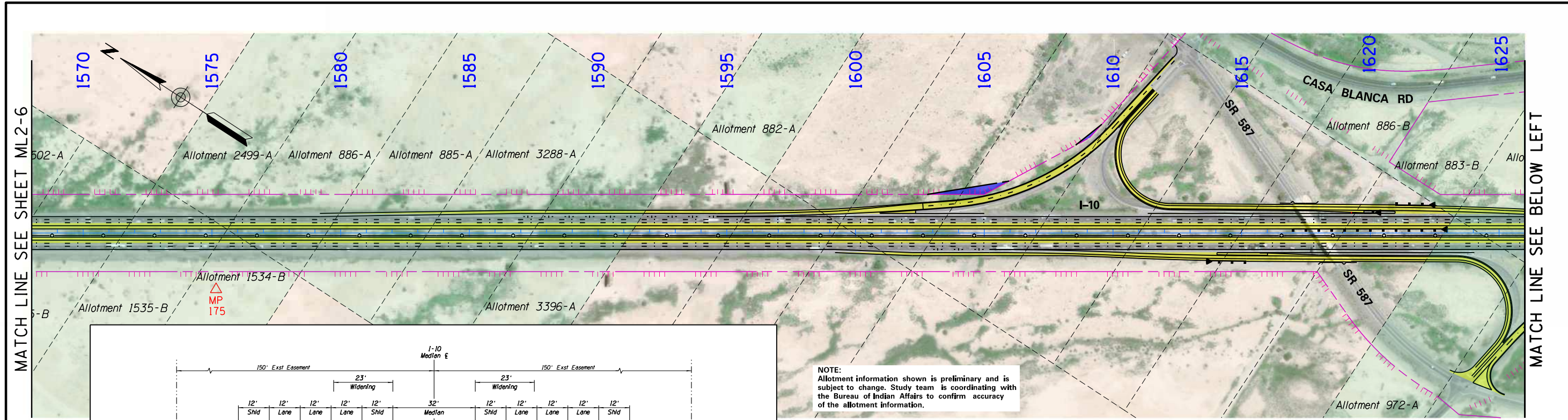

NOTE:  
Allotment information shown is preliminary and is subject to change. Study team is coordinating with the Bureau of Indian Affairs to confirm accuracy of the allotment information.

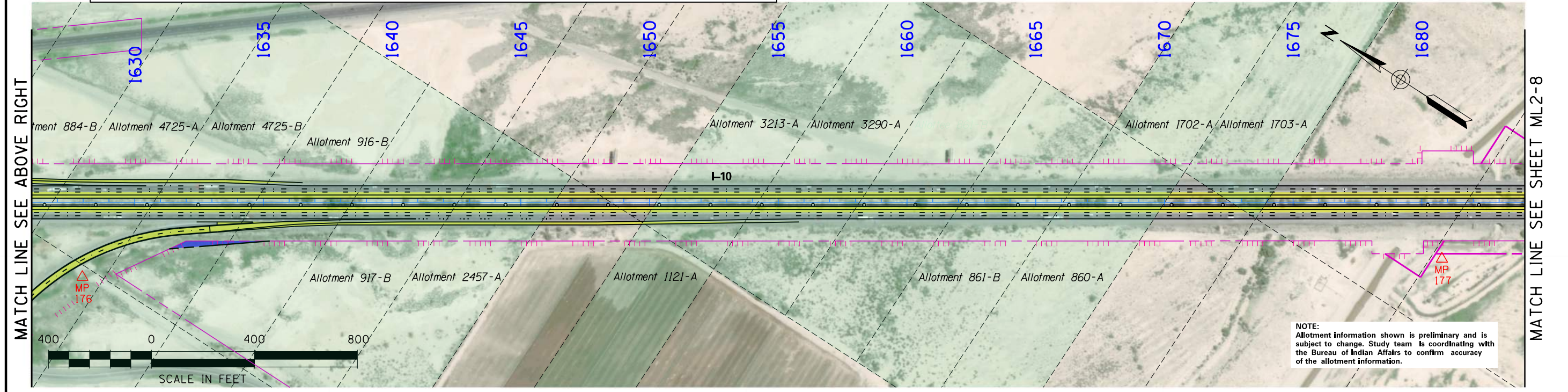

NOTE:  
Allotment information shown is preliminary and is subject to change. Study team is coordinating with the Bureau of Indian Affairs to confirm accuracy of the allotment information.



October 9, 2020

**I-10 / LOOP 202 TO SR 387  
WILD HORSE PASS CORRIDOR  
ALTERNATIVE ML2**

Allotment Parcels	Temporary Construction Easements	Land Boundary
New Pavement	Existing Easement (Line)	Median Cable Barrier
New Permanent Easements	Control of Access (Hash Marks)	
	MP Milepost	





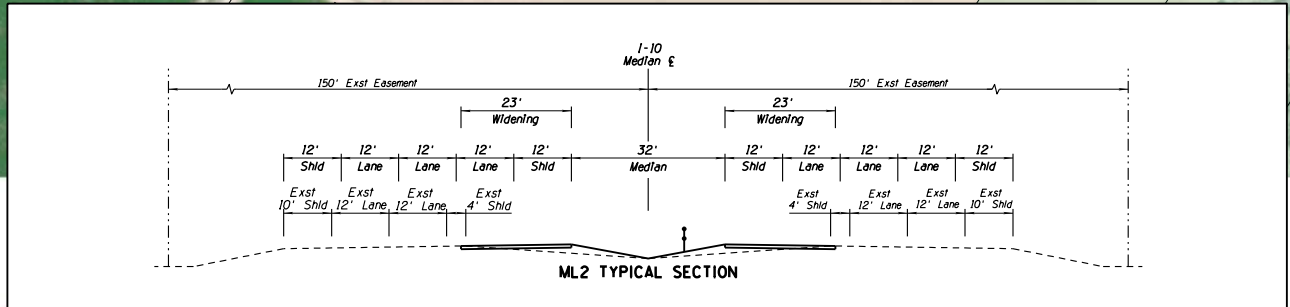
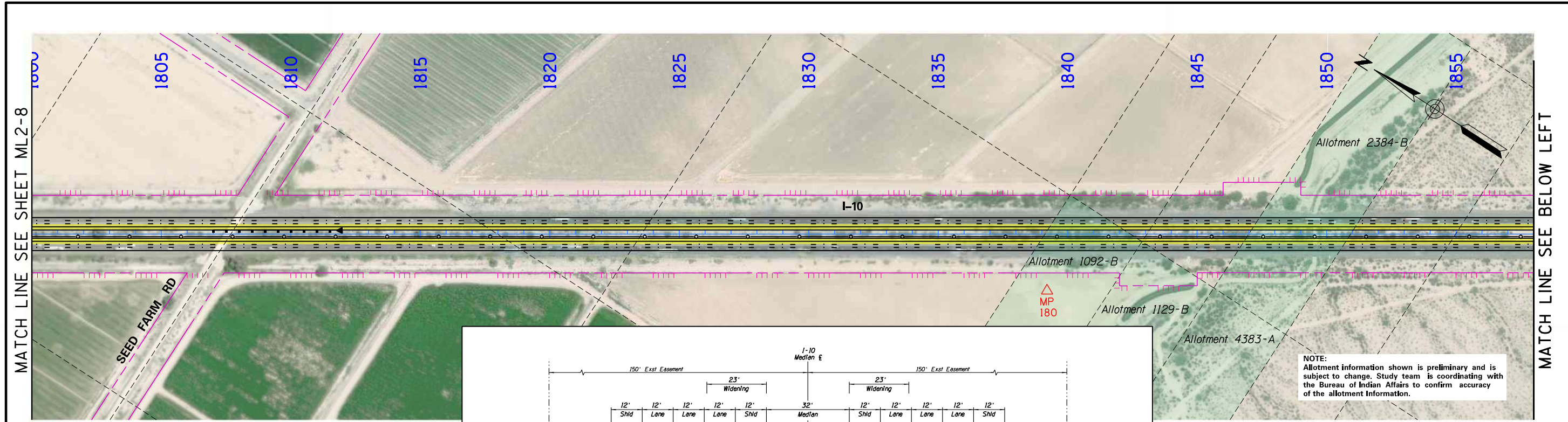

NOTE:  
Allotment information shown is preliminary and is subject to change. Study team is coordinating with the Bureau of Indian Affairs to confirm accuracy of the allotment information.

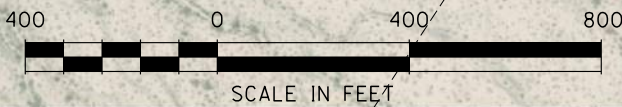
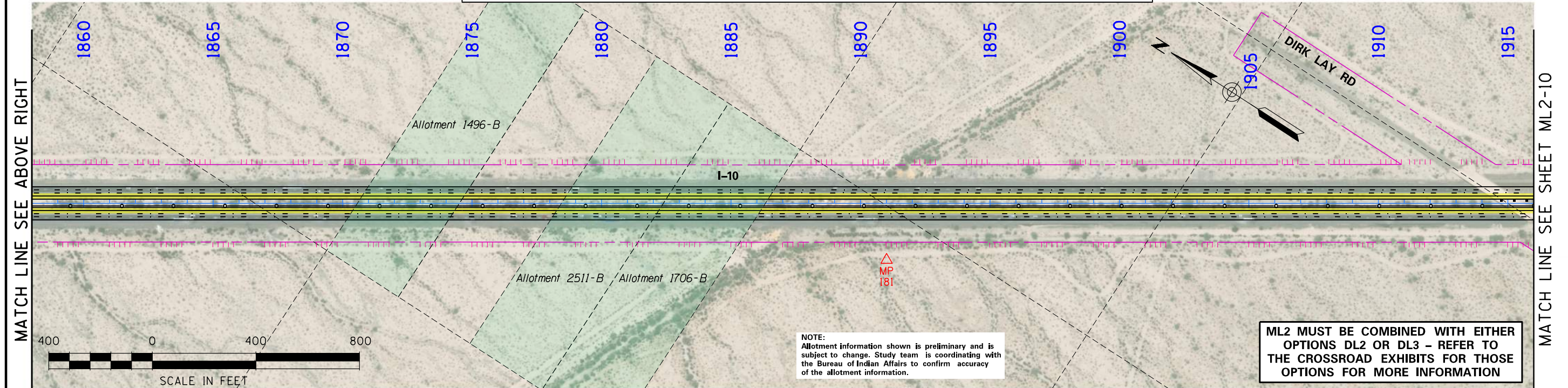

NOTE:  
Allotment information shown is preliminary and is subject to change. Study team is coordinating with the Bureau of Indian Affairs to confirm accuracy of the allotment information.

ML2 MUST BE COMBINED WITH EITHER OPTIONS DL2 OR DL3 - REFER TO THE CROSSROAD EXHIBITS FOR THOSE OPTIONS FOR MORE INFORMATION



October 9, 2020

I-10 / LOOP 202 TO SR 387  
WILD HORSE PASS CORRIDOR  
ALTERNATIVE ML2

LEGEND	
	Allotment Parcels
	New Pavement
	New Permanent Easements
	Temporary Construction Easements
	Existing Easement (Line)
	Control of Access (Hash Marks)
	MP Milepost
	Land Boundary
	Median Cable Barrier

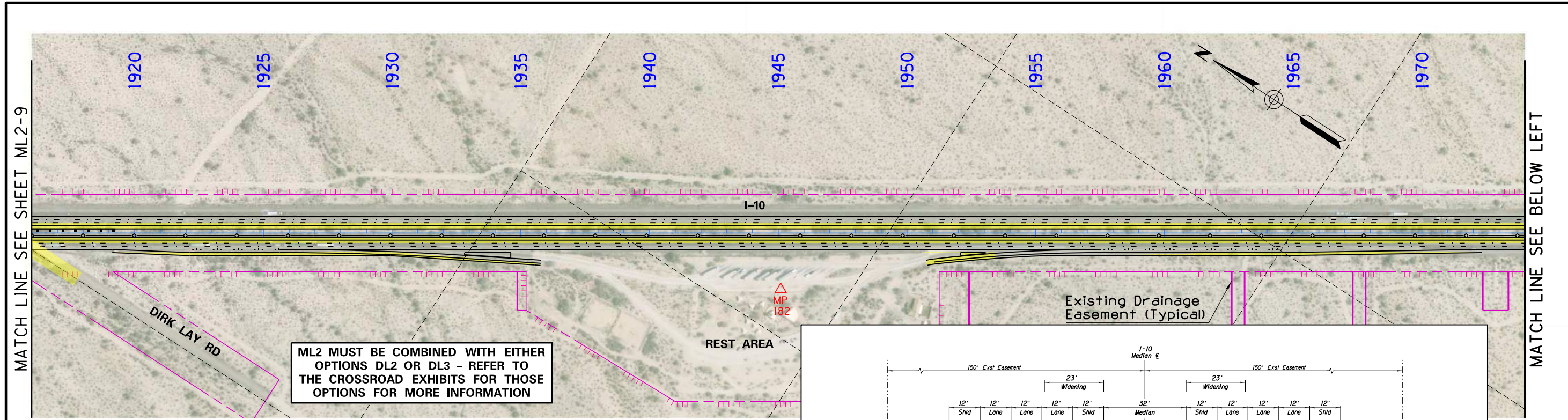

ML2 MUST BE COMBINED WITH EITHER OPTIONS DL2 OR DL3 - REFER TO THE CROSSROAD EXHIBITS FOR THOSE OPTIONS FOR MORE INFORMATION

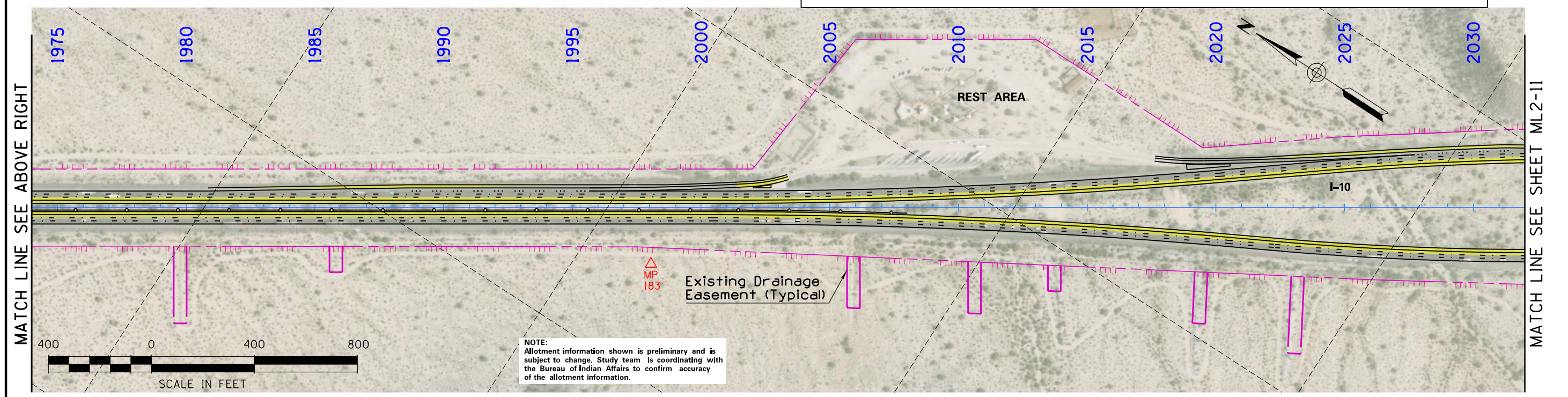
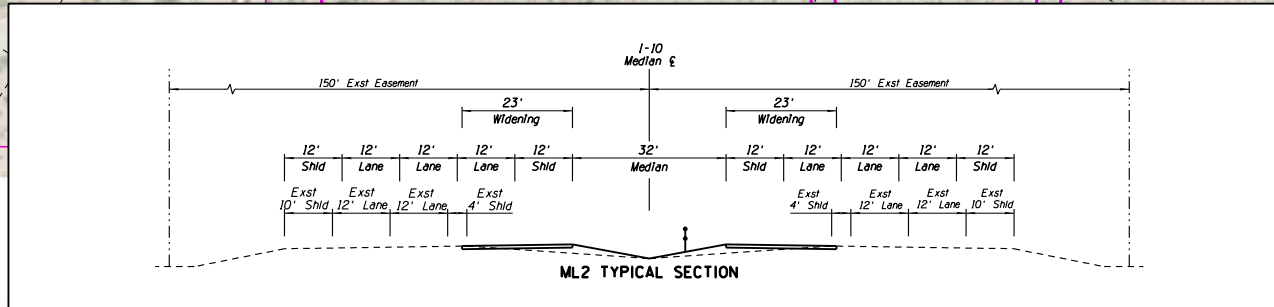

NOTE: Allotment information shown is preliminary and is subject to change. Study team is coordinating with the Bureau of Indian Affairs to confirm accuracy of the allotment information.

**I-10 / LOOP 202 TO SR 387  
WILD HORSE PASS CORRIDOR  
ALTERNATIVE ML2**

**LEGEND**

<ul style="list-style-type: none"> <li><span style="display: inline-block; width: 20px; height: 10px; background-color: #90EE90; border: 1px solid black; margin-right: 5px;"></span> Allotment Parcels</li> <li><span style="display: inline-block; width: 20px; height: 10px; background-color: #FFFF00; border: 1px solid black; margin-right: 5px;"></span> New Pavement</li> <li><span style="display: inline-block; width: 20px; height: 10px; background-color: #0000FF; border: 1px solid black; margin-right: 5px;"></span> New Permanent Easements</li> </ul>	<ul style="list-style-type: none"> <li><span style="display: inline-block; width: 20px; height: 10px; background-color: #00BFFF; border: 1px solid black; margin-right: 5px;"></span> Temporary Construction Easements</li> <li><span style="display: inline-block; width: 20px; border-bottom: 1px dashed pink; margin-right: 5px;"></span> Existing Easement (Line)</li> <li><span style="display: inline-block; width: 20px; border-bottom: 1px dashed black; margin-right: 5px;"></span> Control of Access (Hash Marks)</li> <li><span style="color: red; font-weight: bold;">MP</span> Milepost</li> </ul>	<ul style="list-style-type: none"> <li><span style="display: inline-block; width: 20px; border-bottom: 1px dashed black; margin-right: 5px;"></span> Land Boundary</li> <li><span style="display: inline-block; width: 20px; border-bottom: 1px solid black; margin-right: 5px;"></span> Median Cable Barrier</li> </ul>
-------------------------------------------------------------------------------------------------------------------------------------------------------------------------------------------------------------------------------------------------------------------------------------------------------------------------------------------------------------------------------------------------------------------------------------------------------------------------------------------------------------------------------------------------------------------------	-----------------------------------------------------------------------------------------------------------------------------------------------------------------------------------------------------------------------------------------------------------------------------------------------------------------------------------------------------------------------------------------------------------------------------------------------------------------------------------------------------------------------------------------------------------------------------------------------------------------	--------------------------------------------------------------------------------------------------------------------------------------------------------------------------------------------------------------------------------------------------------------------------------------------------------------------------

**ML2-10  
SHEET 10 of 12**

October 9, 2020



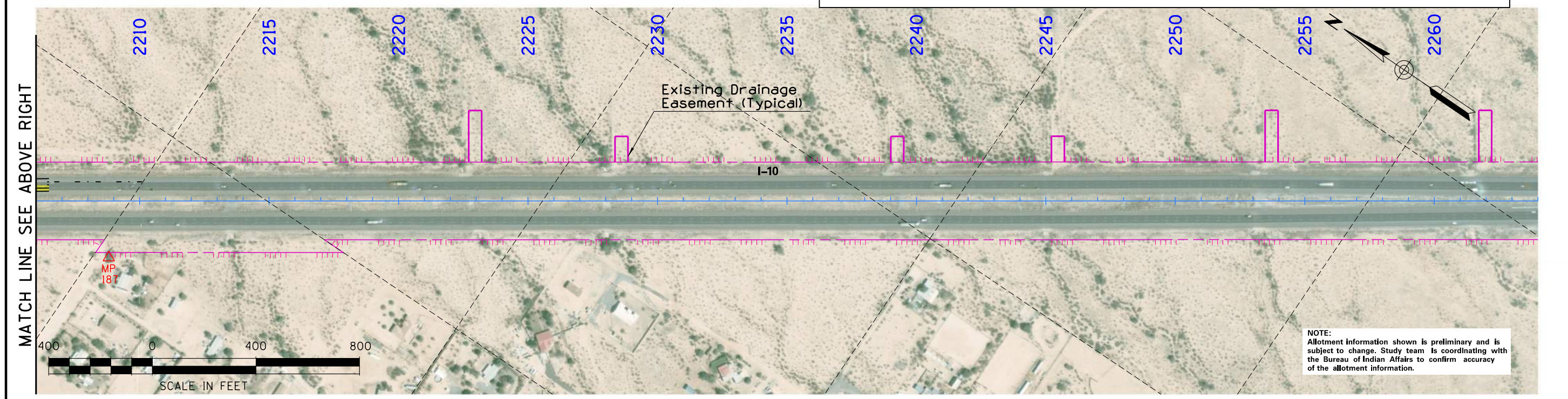
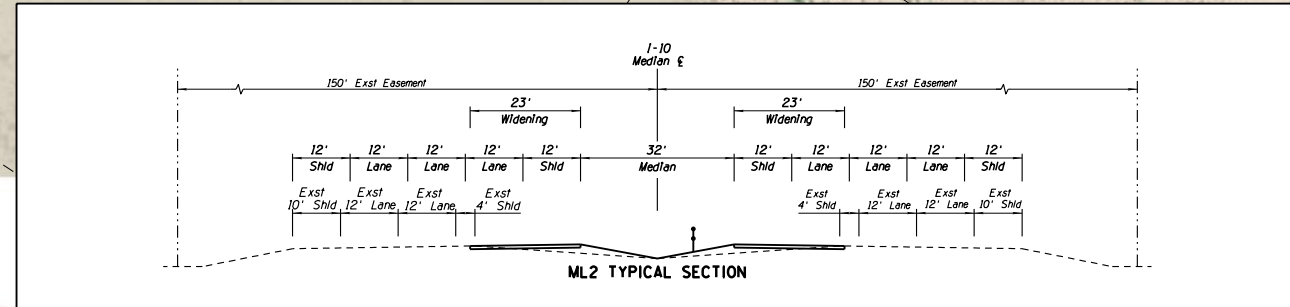
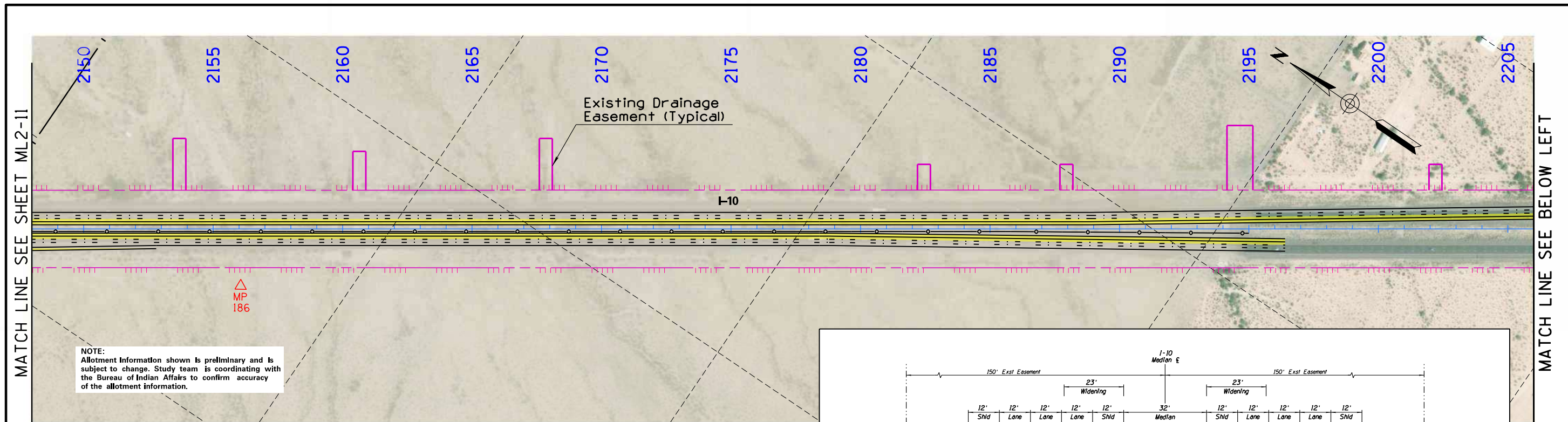



**October 9, 2020**

**I-10 / LOOP 202 TO SR 387  
WILD HORSE PASS CORRIDOR  
ALTERNATIVE ML2**

**LEGEND**

<span style="display: inline-block; width: 15px; height: 10px; background-color: #90EE90; border: 1px solid black;"></span> Allotment Parcels	<span style="display: inline-block; width: 15px; height: 10px; background-color: #00BFFF; border: 1px solid black;"></span> Temporary Construction Easements	<span style="display: inline-block; width: 15px; border-bottom: 1px dashed black;"></span> Land Boundary
<span style="display: inline-block; width: 15px; height: 10px; background-color: #FFFF00; border: 1px solid black;"></span> New Pavement	<span style="display: inline-block; width: 15px; border-bottom: 1px dashed black;"></span> Existing Easement (Line)	<span style="display: inline-block; width: 15px; border-bottom: 1px dashed black;"></span> Median Cable Barrier
<span style="display: inline-block; width: 15px; height: 10px; background-color: #0000FF; border: 1px solid black;"></span> New Permanent Easements	<span style="display: inline-block; width: 15px; border-bottom: 1px dashed black;"></span> Control of Access (Hash Marks)	<span style="display: inline-block; width: 15px; border-bottom: 1px dashed black;"></span> Milepost

**ML2-12  
SHEET 12 of 12**